

SA TYPE KERB & GUTTER

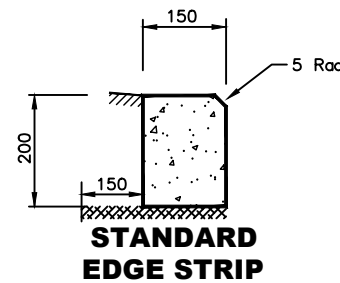

STANDARD EDGE STRIP

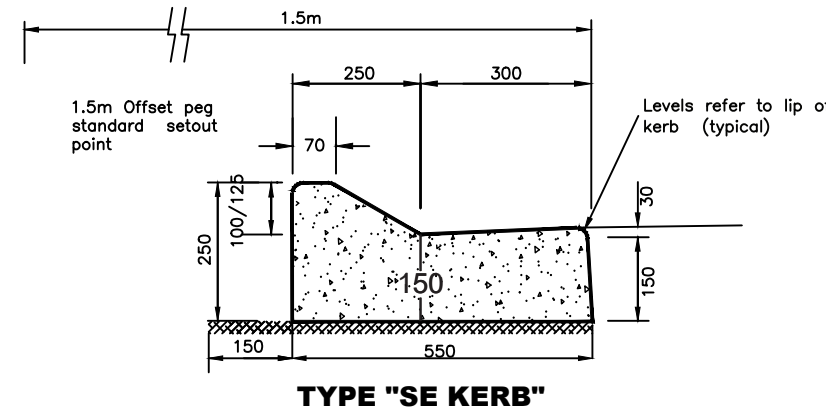

TYPE "SE KERB"

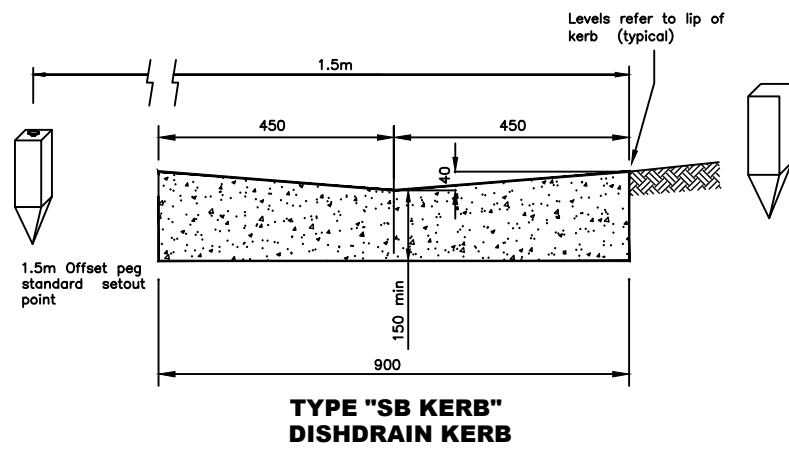

TYPE "SB KERB" DISHDRAIN KERB

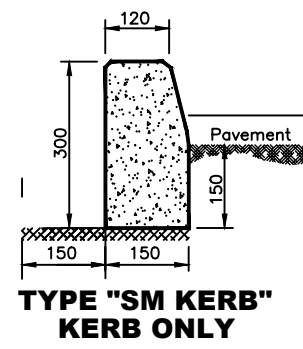

TYPE "SM KERB" KERB ONLY

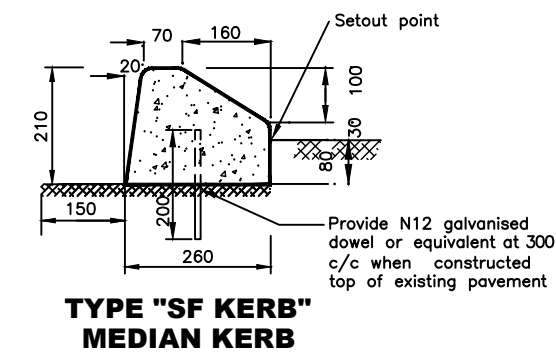

TYPE "SF KERB" MEDIAN KERB

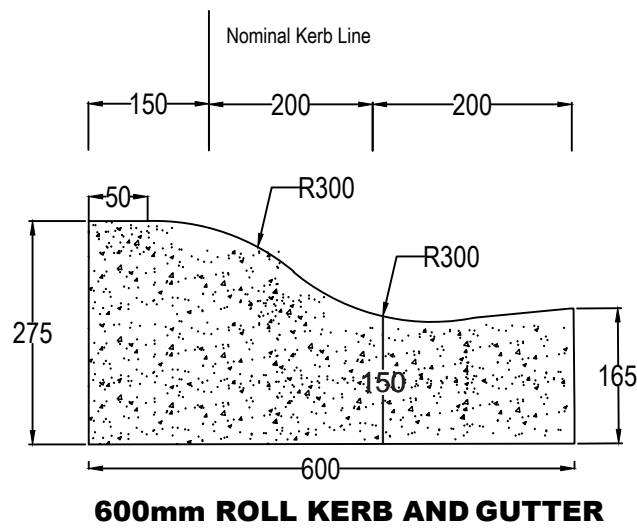

600mm ROLL KERB AND GUTTER

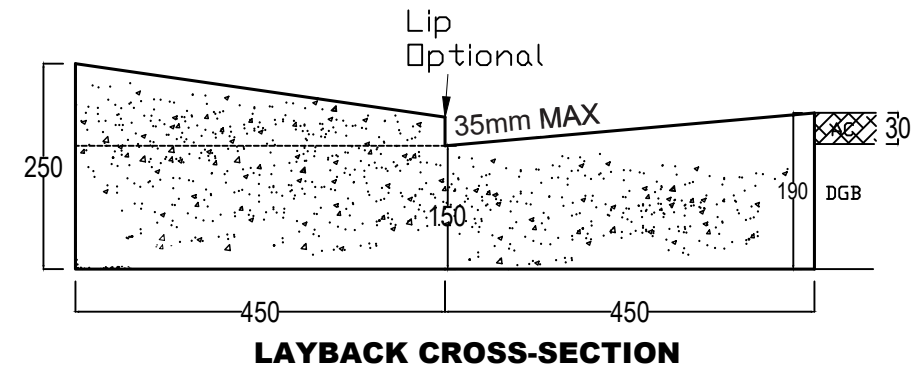

LAYBACK CROSS-SECTION

NOTES:

- Construction shall be in accordance with Shellharbour Engineering Construction Code based on AUS-SPEC.
- Concrete strength to be N32 at 28 days
- Gravel thickness below kerb:
New Road Works: Road Sub-base to be extended under kerbs, gutters, aprons & dish drains
Kerb & Gutter retrofit to existing roads: Provide Sub-base equivalent to existing Sub-base under pavement. Where existing Sub-base depth cannot be determined provide min. 200mm roadbase compacted to 98% standard dry density. Road Sub-base to extend 150mm behind back of kerb.
- Setout requirements, unless shown otherwise shall be
Kerb & Gutter - Setout 1.50m behind lip of kerb
- Setout radii less than 1m at centre points
- Levels to lip of kerb
Dish Drains - Setout 1.50m behind lip of kerb
- Setout to radii less than 1m at centre points
- Levels to lip
- Backfill behind kerb to full height of kerb.
- Radius < 2.0m - CP & TP
Radius > 2.0m & < 5m - TP & mid point
Radius > 5m - TP & 3m segments
- All dimensions in millimetres unless otherwise stated

SCALES SURVEYED: _____ OFFICER: _____ DATE: _____ SURVEY MARKS: _____	LIST OF REVISIONS REV. DATE OFFICER A. 19/12/2019 BH B. 17/06/2021 PW	AMENDMENT DETAILS _____ _____	APPROVED - Manager Technical Services DATE: _____		LOCATIONS SERVICES Services shown are those known to exist at date of design. Prior to commencement of excavation contact the relevant gas, electricity, water and telecommunications service providers, including the RMS, for most recent service locations and precautions that may be necessary	LEGEND Gas: — G — Electricity: — E — Water: — W — Sewer: — S — TelComm Local Cable: — T — TelComm Major or Optic Fibre: — MOF —	ADMINISTRATION CENTRE SHELLHARBOUR CIVIC CENTRE 76 CYGNET AVENUE (Cnr Cygnet & College Avenue) POSTAL ADDRESS Locked Bag 155 SHELLHARBOUR CITY CENTRE NSW 2529 PH: (02) 4221 6111 FAX: (02) 4221 6016 DX26402 SHELLHARBOUR CITY CENTRE	PLAN DETAILS		FILE: _____	REVISION B
			SCC STANDARD DRAWING VEHICLE CROSSING - RESIDENTIAL					PLAN No: ASD 200	SHEET: _____		

LEGEND

IJ - Isolation Joint

EJ - Expansion Joint

X =GUTTER INVERT TO BOUNDARY WIDTH in mm	L1	L2
2740	790	300
3050	1100	300
3350	1400	300
3660	1400	610
4570	1400	1520

STANDARD RESIDENTIAL DRIVEWAY AND FOOTPATH CROSSINGS WITH WINGS

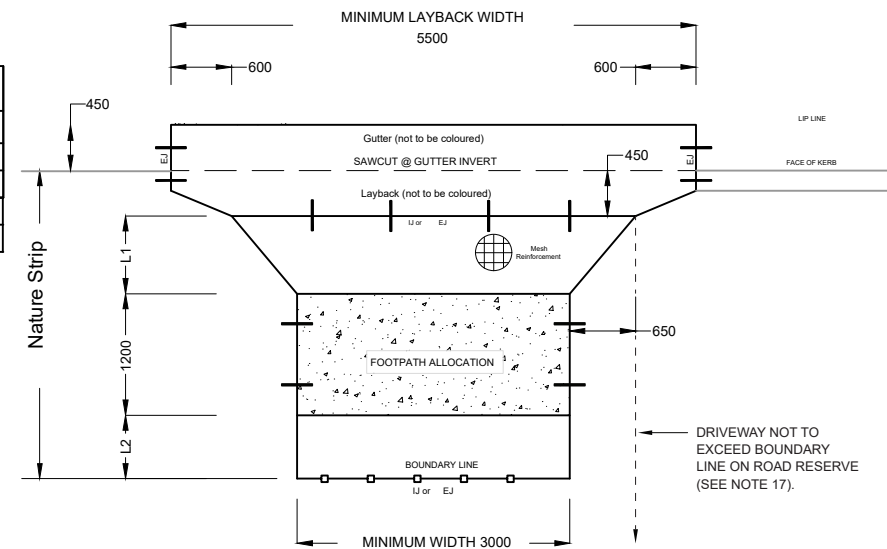

STANDARD RESIDENTIAL DRIVEWAY AND FOOTPATH CROSSINGS WITHOUT WINGS

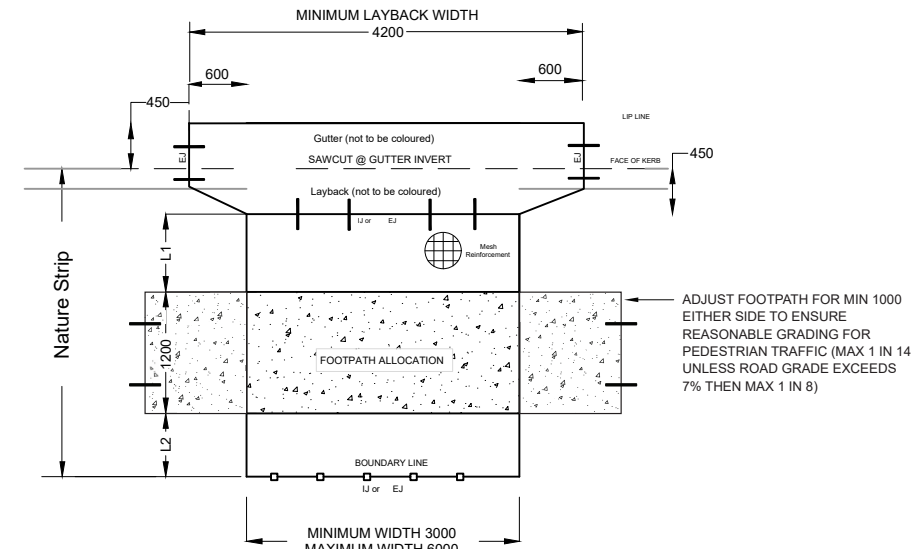

NOTES:

- DRIVEWAY THICKNESS IS TO BE A MINIMUM 150mm SL72 STEEL MESH REINFORCED. INDUSTRIAL AND COMMERCIAL CROSSINGS MUST BE ENGINEER DESIGNED FOR EXPECTED TRAFFIC LOADS.
- FOOTPATH SECTION AND VERGE PROFILE TO VARY WHERE NECESSARY TO MATCH COMPLETED DRIVEWAY. EARTHWORKS ADJOINING COMPLETED DRIVEWAY AND FOOTPATH MUST BE COMPACTED TO A FLUSH FINISH WITHOUT TRIP HAZARDS TO AVOID A PUBLIC SAFETY HAZARD.
- CONCRETE SURFACE TOLERANCE TO BE ±5mm OVER 3m SECTIONS
- CONCRETE N25 IN ACCORDANCE WITH AS1379 & AS3600
- REINFORCEMENT MESH TO AS1304, 50mm TOP AND EDGE COVER, LAP MESH 250mm
- EXPANSION JOINTS TO BE 10mm THICK, FULL DEPTH CLOSED CELL CROSS LINKED POLYETHYLENE FOAM (150kg/m), INSTALLATION TO MANUFACTURERS INSTRUCTIONS. EXPANSION JOINTS TO BE DOWELED. SEE PAGE 1 FOR TYPICAL DOWEL DETAIL.
- MINIMUM LAYBACK WIDTH IS TO BE DRIVEWAY WIDTH + 1200mm (2 x 600mm).
- AFTER EXCAVATION FOR DRIVEWAY HAS BEEN CARRIED OUT ALL SOFT, YIELDING OR OTHER UNSUITABLE AREAS OF SUBGRADE MUST BE REPLACED WITH SOUND MATERIAL AND COMPACTED.
- FOR RESIDENTIAL DRIVEWAYS A MINIMUM OF 50mm COMPACTED ROAD BASE LAYER IS TO BE PROVIDED. FOR INDUSTRIAL, COMMERCIAL AND DEVELOPMENTS WITH HIGH TRAFFIC LOADS, BASE AND DRIVEWAY IS TO BE ENGINEER DESIGNED.
- A ROAD OPENING PERMIT UNDER SECTION 138 OF THE ROADS ACT MUST BE OBTAINED FROM COUNCIL. SEEK APPROVAL OF LOCATION AND LEVELS PRIOR TO EXCAVATION.
- GRADE NOT TO EXCEED 1:8 WHERE DISABILITY ACCESS IS REQUIRED.
- WHERE DRIVEWAY PROVIDES STACKED PARKING, A MAXIMUM GRADE & CROSSFALL OF 6.25% & 5% RESPECTIVELY ARE REQUIRED.
- WHERE CONSTRUCTING DRIVEWAY/LAYBACK INTO EXISTING KERB, THE FOLLOWING DETAILS ARE TO BE ADHERED TO
 - SAW CUT IS TO BE CARRIED OUT AT INVERT OF GUTTER & AT BOTH ENDS OF LAYBACK WIDTH ACROSS KERB
 - SAW CUT IS TO BE CARRIED OUT THROUGH DEPTH OF CONCRETE
 - EXISTING KERB (BARRIER & MOUNTABLE) IS TO BE REMOVED
 - REPLACEMENT KERB TO HAVE DOWELLED EXPANSION JOINT AT EITHER END
 - LAYBACK MUST BE CONSTRUCTED OF PLAIN CONCRETE
 - RESTORE ANY DAMAGED BITUMEN.
- LIP BETWEEN EDGE OF LAYBACK AND THE GUTTER OPTIONAL, MAX 35mm
- ALL STEEL REINFORCEMENT IS TO COMPLY WITH AS 1302, AS 1303 & AS 1304.
- ALL DIMENSIONS IN MILLIMETRES UNLESS STATED OTHERWISE
- DRIVEWAY DISTANCE FROM INTER-ALLOTMENT BOUNDARY LINE IN THE ROAD RESERVE IS TO BE A MINIMUM OF 650MM TO ENSURE THE WING DOES NOT ENCROACH ONTO THE NEIGHBOURING PROPERTY.

STANDARD RESIDENTIAL DRIVEWAY AND FOOTPATH CROSSINGS - ROLL TYPE KERB

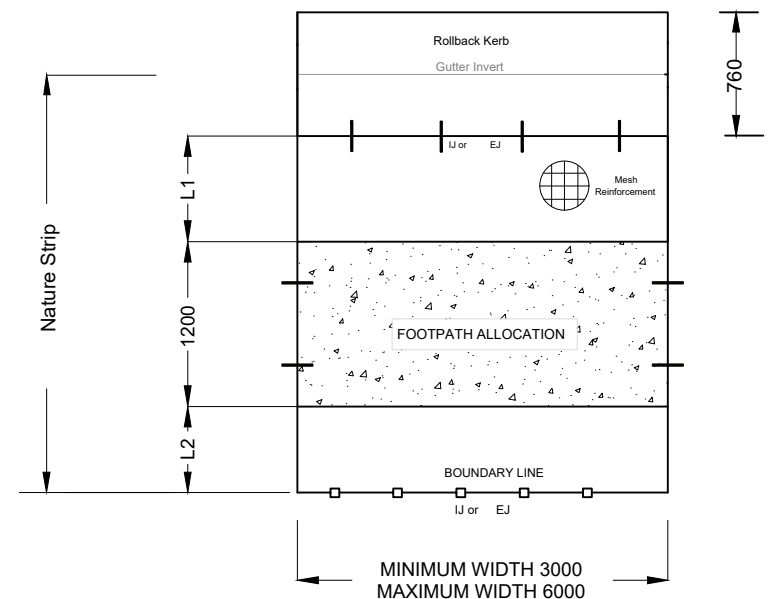

SCALES SURVEYED: _____ OFFICER: _____ DATE: _____ SURVEY MARKS: _____	LIST OF REVISIONS REV. DATE OFFICER A. 19/12/2019. SH B. 17/06/2021. PW	AMENDMENT DETAILS _____ _____	APPROVED - Manager Technical Services DATE: _____		LOCATIONS SERVICES Gas: - - - G - - - Electricity: - - - E - - - Water: - - - W - - - Sewer: - - - S - - - TelComm Local Cable: - - - T - - - TelComm Major or Optic Fibre: - - - MOF - - -	ADMINISTRATION CENTRE SHELLHARBOUR CIVIC CENTRE 76 CYGNET AVENUE (Cnr Cygnet & College Avenue) POSTAL ADDRESS Locked Bag 155 SHELLHARBOUR CITY CENTRE NSW 2529 PH: (02) 4221 6111 FAX: (02) 4221 6016 DX26402 SHELLHARBOUR CITY CENTRE	<h1>PLAN DETAILS</h1>		FILE:	REVISION
			DESIGNED: Patrick Walker DATE: 17/06/2021 DRAWN: Patrick Walker DATE: 17/06/2021				SEDIMENT AND EROSION CONTROL Provide sediment and erosion control measures in accordance with the 'Erosion & Sediment Control' guide by the NSW Office of Environment & Heritage	<h2>SCC STANDARD DRAWING VEHICLE CROSSING - RESIDENTIAL</h2>		PLAN No: ASD 201

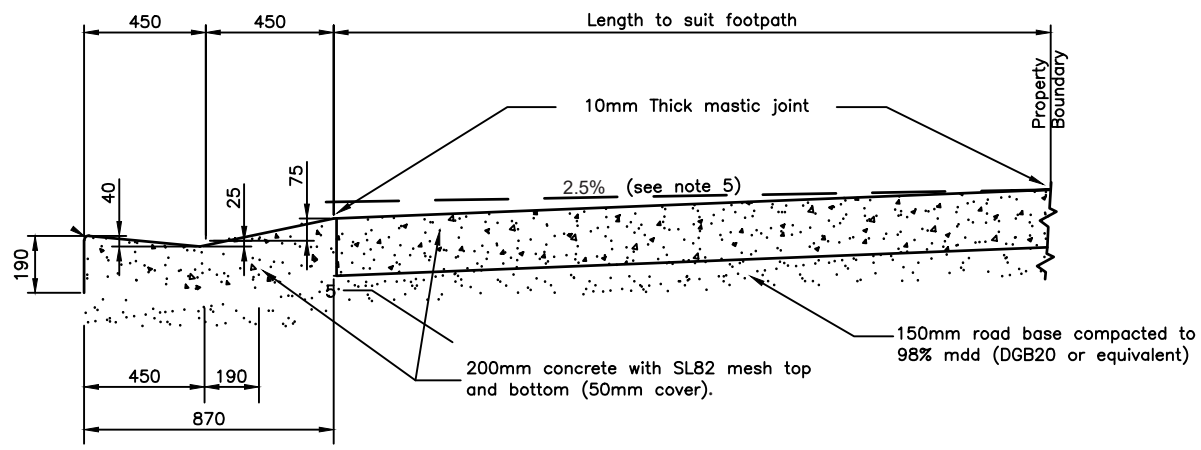

CROSS SECTION

NOTES:

1. All dimensions in millimetres unless otherwise stated.
2. Concrete strength to be N32 at 28 days.
3. All edges to be shaped with an edging tool.
4. Joints to be placed at 4.0m to 6.0m centres.
5. Variations to footpath crossfall to be approved by Council prior to construction.
6. Width of crossing as approved by Council to suit turning movement.
7. Provision for services under slab to be investigated prior to construction.
8. Provide expansion joints at connections to kerbs and ramps.
9. Driveway distance from inter-allotment boundary line in the road reserve is to be a minimum of 650mm to ensure the wing does not encroach onto the neighbouring property.
10. Where the new driveway is below or above ground level, the soil in the road reserve is to be battered or filled to the finished level of the driveway to prevent a trip hazard to pedestrians.
11. Footpath thickness to be a minimum of 125mm with SL72 steel mesh reinforced in the road reserve.

LEGEND

IJ - Isolation Joint
EJ - Expansion Joint

FOOTPATH WIDTH	L1	L2
2740	790	300
3050	1100	300
3350	1400	300
3660	1400	610
4570	1400	1520
5490	1400	2440
6100	1400	3050

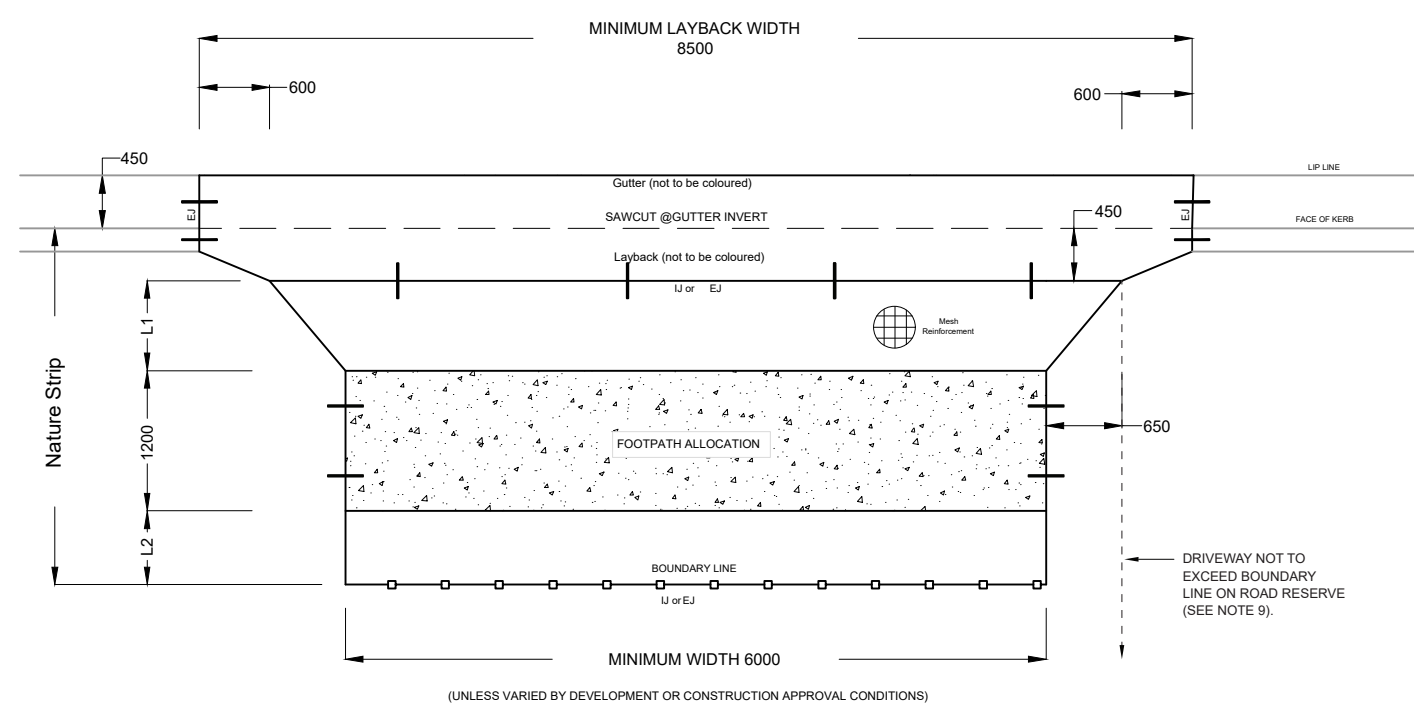

STANDARD INDUSTRIAL DRIVEWAY AND FOOTPATH CROSSINGS OPTION 1

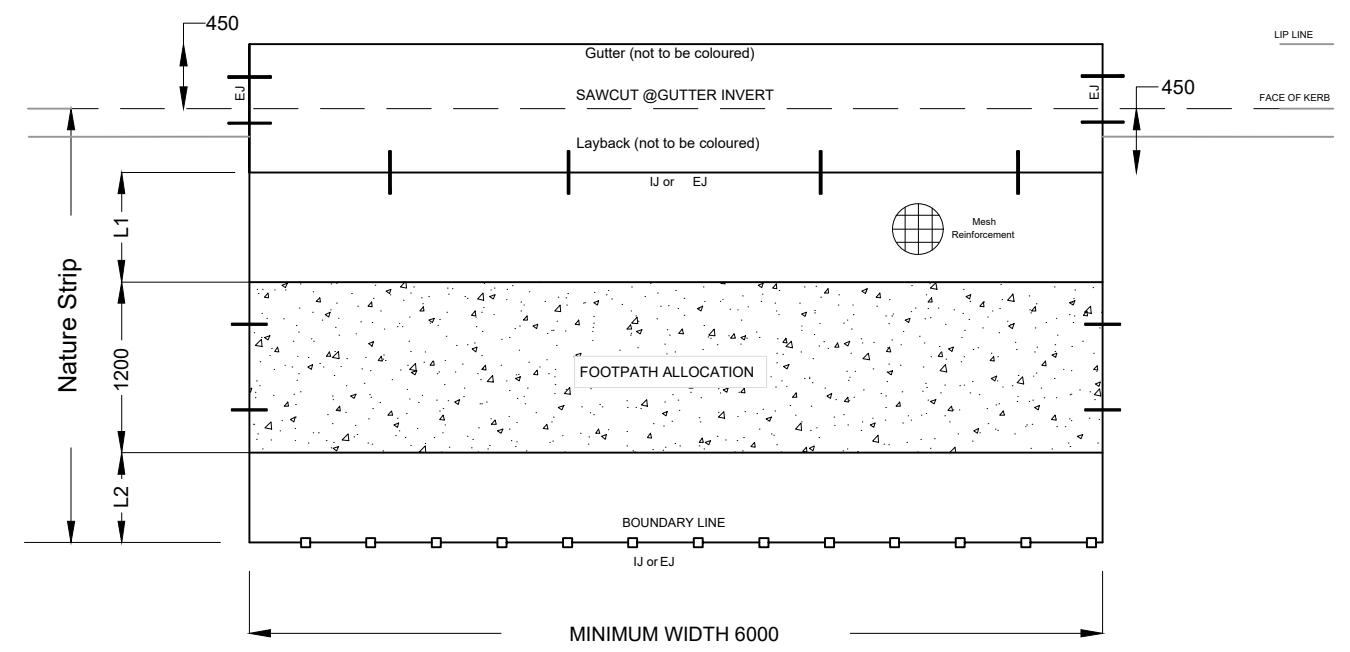

STANDARD INDUSTRIAL DRIVEWAY AND FOOTPATH CROSSINGS OPTION 2

SCALES SURVEYED: OFFICER: DATE: SURVEY MARKS:	LIST OF REVISIONS REV. DATE OFFICER A. 18/12/2019. BH. B. 17/06/2021. PW.	AMENDMENT DETAILS	APPROVED - Manager Technical Services DATE: DESIGNED: Patrick Walker DATE: 17/06/2021 DRAWN: Patrick Walker DATE: 17/06/2021	LOCATIONS SERVICES Services shown are those known to exist at date of design. Prior to commencement of excavation contact the relevant gas, electricity, water and telecommunications service providers, including the RMS, for most recent service locations and precautions that may be necessary.	LEGEND Gas: — G — Electricity: — E — Water: — W — Sewer: — S — TelComm Local Cable: — T — TelComm Major or Optic Fibre: — MOF —	ADMINISTRATION CENTRE SHELLHARBOUR CIVIC CENTRE 76 CYGNET AVENUE (Cnr Cygnet & College Avenue) POSTAL ADDRESS Locked Bag 155 SHELLHARBOUR CITY CENTRE NSW 2529 PH: (02) 4221 6111 FAX: (02) 4221 6016 DX26402 SHELLHARBOUR CITY CENTRE	PLAN DETAILS SCC STANDARD DRAWING VEHICLE CROSSING - RESIDENTIAL	FILE: PLAN No: ASD 202	REVISION B SHEET:
	SHEET:		SHEET:		SHEET:		SHEET:		SHEET:

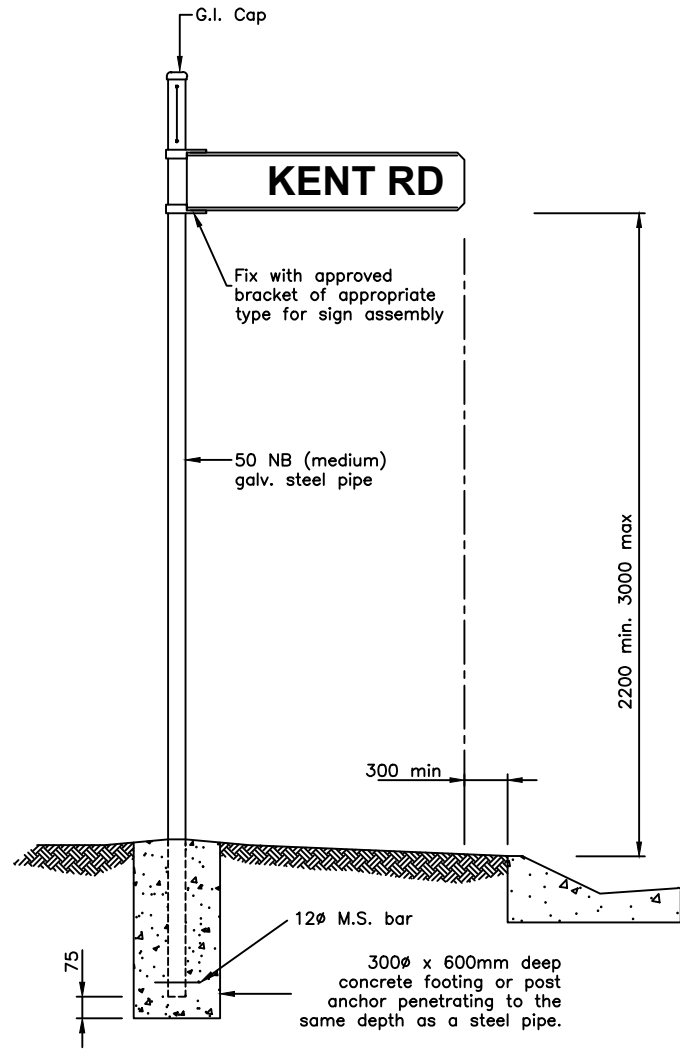

ELEVATION

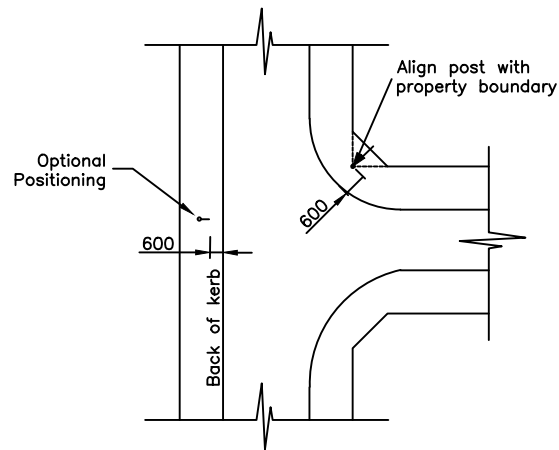

LOCATION OF SIGNS

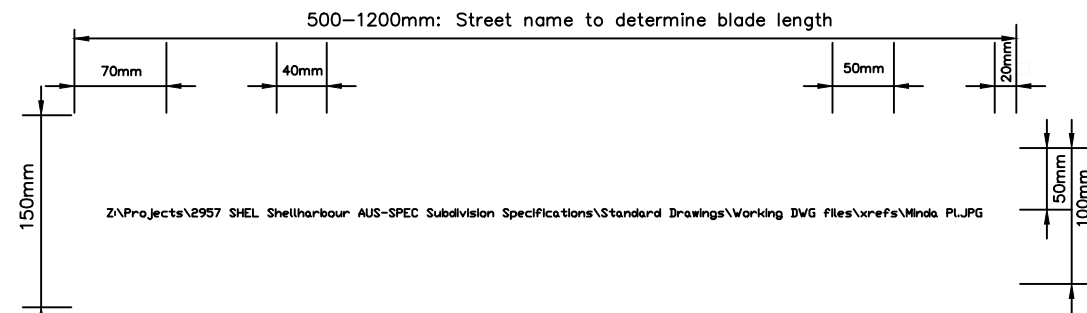

STANDARD STREET SIGN

NOTES

1. Lettering for street name to be standard road sign lettering, as set out in AS AS 1744.
2. Street blades 500mm up to 800mm to utilise series D font. All signs that exceed 800mm to utilise series C font as set out in AS 1744 with appropriate letter spacing.
3. Dimensions, legend, background as per requirements of AS 1742.5, AS 1743 and AS 1744.
4. Legend to be 100% opacity Black.
5. Background Class 1 - White retroflective sheeting of that class as defined by in AS/NZ 1906.1.
6. Signs up to 1200mm in length to be constructed from 150mm x 6mm Aluminium sheet.
7. Double direction top mounted street blade to be constructed from Extruded "I" beam Aluminium.
8. Sign to minimum length 500mm and a maximum length of 1200mm as set out in AS 1742.5.
9. Holes on sign to match 1-way (AL15 150mm) street blade mounting bracket.
10. Logo as per supplied.
11. Logo to be placed as per detail drawing and in conjunction AS 1742.5 with Appendix B. Located at support end, both sides. **Note:** lettering to be done as per general requirements and only include the logo if street name can be maintained with max sign length.
12. Bracket end to logo 70mm, between logo to street name 40mm, street name to sign end 20mm.
13. Street type abbreviation size to be half height as per AS1742.5.

Z:\Projects\2957 SHEL Shellharbour AUS-SPEC Subdivision Specifications\Standard Drawings\Working DWG files\xrefs\Goolagong CCT.JPG

DOUBLE DIRECTION TOP MOUNT SIGN

SCALES SURVEYED OFFICER: _____ DATE: _____ SURVEY MARKS: _____	LIST OF REVISIONS REV. DATE OFFICER .A. 18/12/2019 .BH. .B. 17/06/2021 .PW.	AMENDMENT DETAILS APPROVED - Manager Technical Services DATE: _____ DESIGNED: Patrick Walker DATE: 17/06/2021 DRAWN: Patrick Walker DATE: 17/06/2021	LOCATIONS SERVICES LEGEND Gas: - - - G - - - Electricity: - - - E - - - Water: - - - W - - - Sewer: - - - S - - - TelComm Local Cable: - - - T - - - TelComm Major or Optic Fibre: - - - MOF - - -	 ADMINISTRATION CENTRE SHELLHARBOUR CIVIC CENTRE 76 CYGNET AVENUE (Cnr Cygnet & College Avenue) POSTAL ADDRESS Locked Bag 155 SHELLHARBOUR CITY CENTRE NSW 2529 PH: (02) 4221 6111 FAX: (02) 4221 6016 DX26402 SHELLHARBOUR CITY CENTRE	PLAN DETAILS		FILE: _____ REVISION B
					STANDARD STREET SIGN INSTALLATION		PLAN No: ASD 203 SHEET: _____

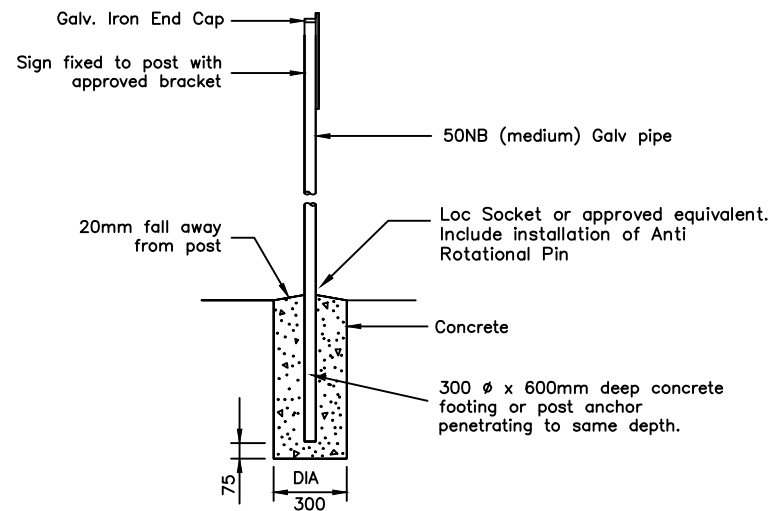

**TYPICAL SIGN & FOOTING DETAIL
(RURAL & URBAN ROADS)**

NOTES:

1. All signs to be reflectorised Class 1 to AS1743 unless noted otherwise.
2. All signs and sign post anchoring details are to be approved by Council prior to erection.
3. All signs shall be in accordance with the AS1742 Manual of Uniform Traffic Control Devices be adopted.
4. Signs shall be aluminium alloy not less than 2mm thick to AS 2848.
5. Equivalent couplings of similar purpose may be used subject to Council approval.
6. All pipes to be galvanised. Steel pipe to AS 1074. Galvanising to AS 1650.
7. Concrete minimum N25 in accordance with AS 3600.
8. All fasteners shall be Tamper / Vandal resistant.
9. Proprietary couplings shall be installed in accordance with manufacturers recommendations.
10. All dimensions in millimetres unless otherwise stated.

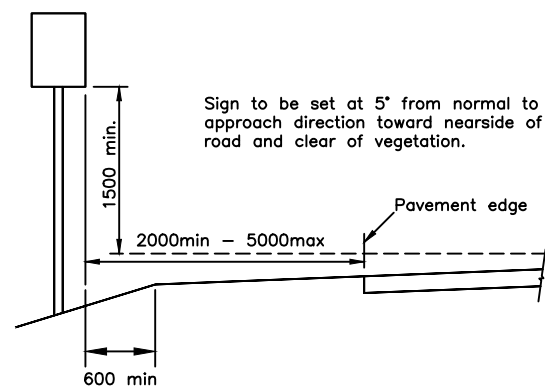

RURAL ROADS

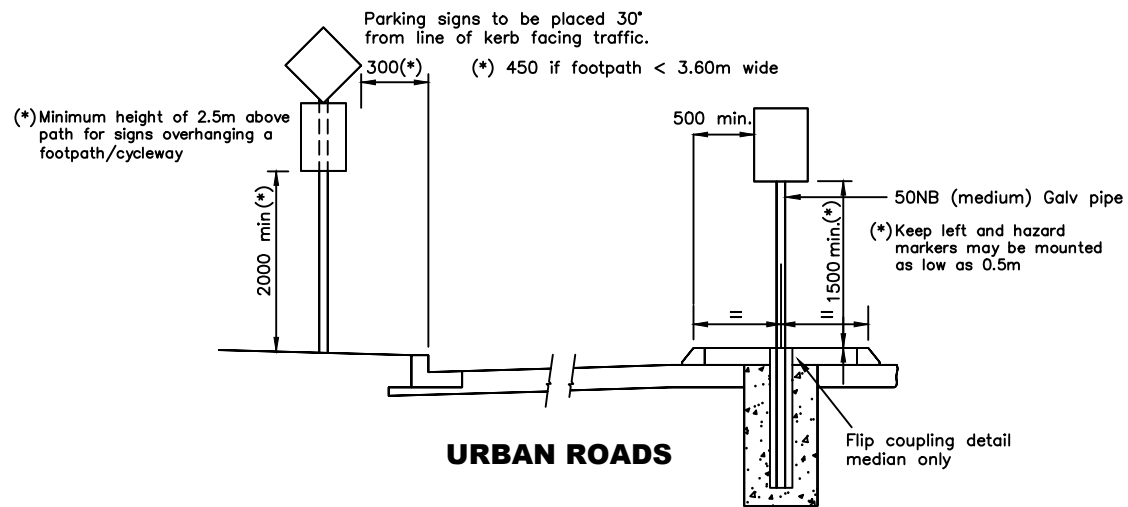

URBAN ROADS



LOCK SOCKET

LOCATION OF SIGNS

SCALES SURVEYED OFFICER: _____ DATE: _____ SURVEY MARKS: _____	LIST OF REVISIONS REV. DATE OFFICER A 19/12/2019 BH B 17/06/2021 PW	AMENDMENT DETAILS _____ _____	APPROVED - Manager Technical Services DATE: _____ DESIGNED: Patrick Walker DATE: 17/06/2021 DRAWN: Patrick Walker DATE: 17/06/2021	LOCATIONS Services shown are those known to exist at date of design. Prior to commencement of excavation contact the relevant gas, electricity, water and telecommunications service providers, including the RMS, for most recent service locations and precautions that may be necessary.	SERVICES LEGEND Gas: — G — Electricity: — E — Water: — W — Sewer: — S — TelComm Local Cable: — T — TelComm Major or Optic Fibre: — MOF —	 ADMINISTRATION CENTRE SHELLHARBOUR CIVIC CENTRE 76 CYGNET AVENUE (Cnr Cygnet & College Avenue) POSTAL ADDRESS Locked Bag 155 SHELLHARBOUR CITY CENTRE NSW 2529 PH: (02) 4221 6111 FAX: (02) 4221 6016 DX26402 SHELLHARBOUR CITY CENTRE	PLAN DETAILS STANDARD RURAL SIGN INSTALLATION	FILE: _____ PLAN No: ASD 204	REVISION B SHEET: _____

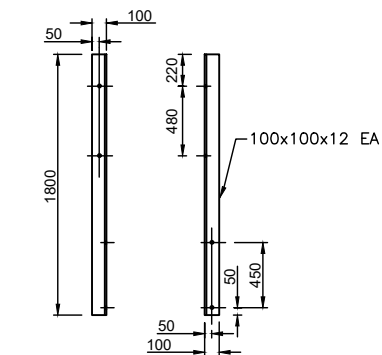
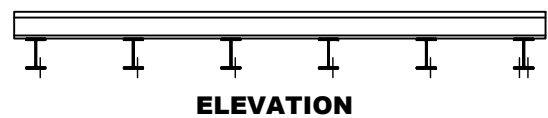
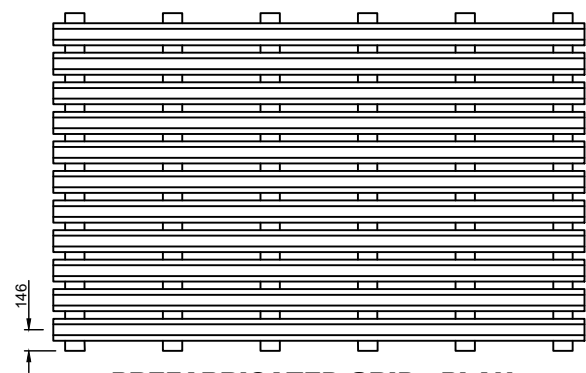
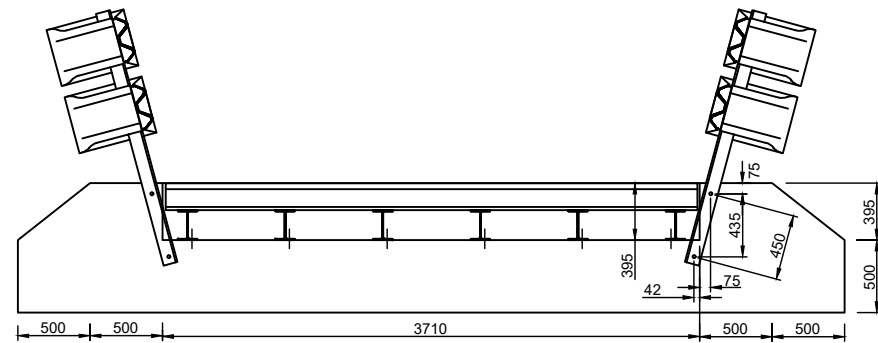
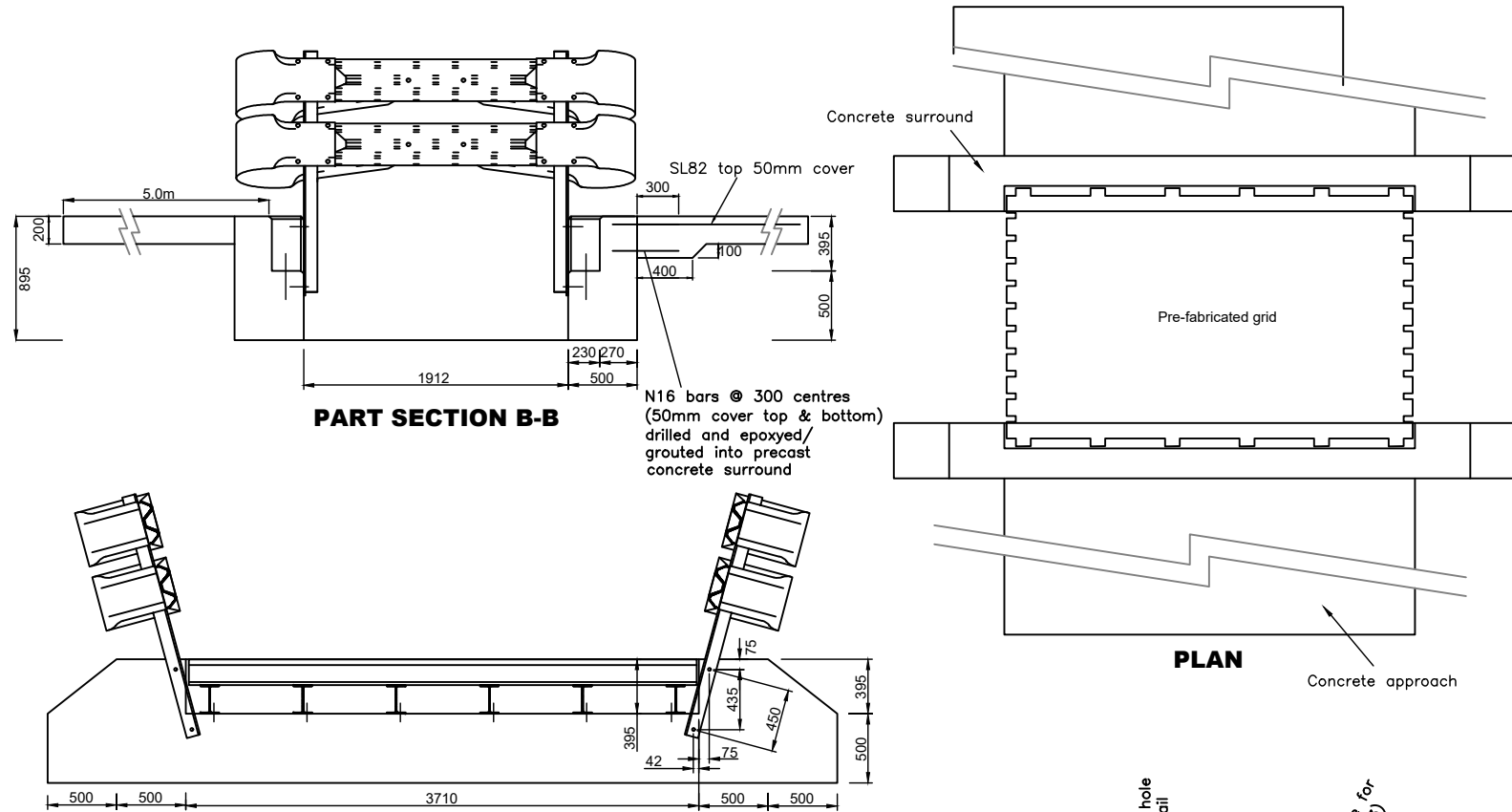

DETAILS OF GUARDRAIL SUPPORT
4 Required
(2 LHS & 2 RHS)

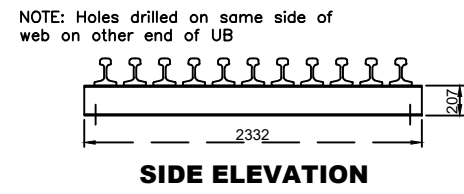
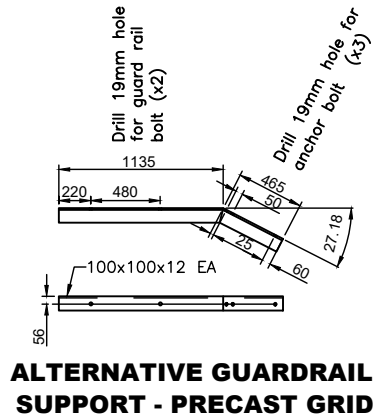

NOTES:

- Public gates to be installed in accordance with the Roads Act 1993, Roads (General) Regulation 1994 or the current Act
- RE68 rails to be fillet welded to 200UB29.8 grade 350 as shown
- All guardrail supports to be hot dip galvanised Guard rails and 3. buffer ends in accordance with RMS drawing MD.RI 32.C02.A or current equivalent drawing
- Retro-reflective transfers G9-257 (L&R) shall be attached to 4. all buffered ends
- A 3.5m min width gate shall be provided adjacent to the grid. The grid shall be constructed centrally on the road 6.
- 'GRID' and 'ONE LANE' signs (W5-16A & W8-16A) shall be installed at the grid on the LHS of both approaches and 100m from the grid on both approaches with min 50m sight distance to the sign
- Approved equivalent precast grids may be installed in lieu of the prefabricated grid detailed
- Concrete shall be min. grade N25 in accordance with AS 8. 3600, reinforcement to be SL82 mesh, with minimum cover of 50mm to top and edges. Reinforcing to be inspected and approved by Council's Supervisor prior to placement of concrete
- Vehicular traffic is not allowed for seven (7) days and is to be cured by covering with polyethylene sheeting for seven (7) days
- All Dimensions are in millimetres unless otherwise stated

SCALES SURVEYED OFFICER: _____ DATE: _____ SURVEY MARKS: _____	LIST OF REVISIONS REV. DATE OFFICER A 19/12/2019 BH B 17/06/2021 PW	AMENDMENT DETAILS _____ _____	APPROVED - Manager Technical Services DATE: _____		SERVICES Gas: - G - Electricity: - E - Water: - W - Sewer: - S - TelComm Local Cable: - T - TelComm Major or Optic Fibre: - MOF -		ADMINISTRATION CENTRE SHELLHARBOUR CIVIC CENTRE 76 CYGNET AVENUE (Cnr Cygnet & College Avenue) POSTAL ADDRESS Locked Bag 155 SHELLHARBOUR CITY CENTRE NSW 2529 PH: (02) 4221 6111 FAX: (02) 4221 6016 DX26402 SHELLHARBOUR CITY CENTRE	PLAN DETAILS		FILE: _____	REVISION
			DESIGNED: Patrick Walker DATE: 17/06/2021 DRAWN: Patrick Walker DATE: 17/06/2021	SEDIMENT AND EROSION CONTROL Provide sediment and erosion control measures in accordance with the 'Erosion & Sediment Control' guide by the NSW Office of Environment & Heritage				3.7M WIDE CATTLE GRID		PLAN No: _____	SHEET: _____

STANDARD DRIVEWAY LONG-SECTIONS

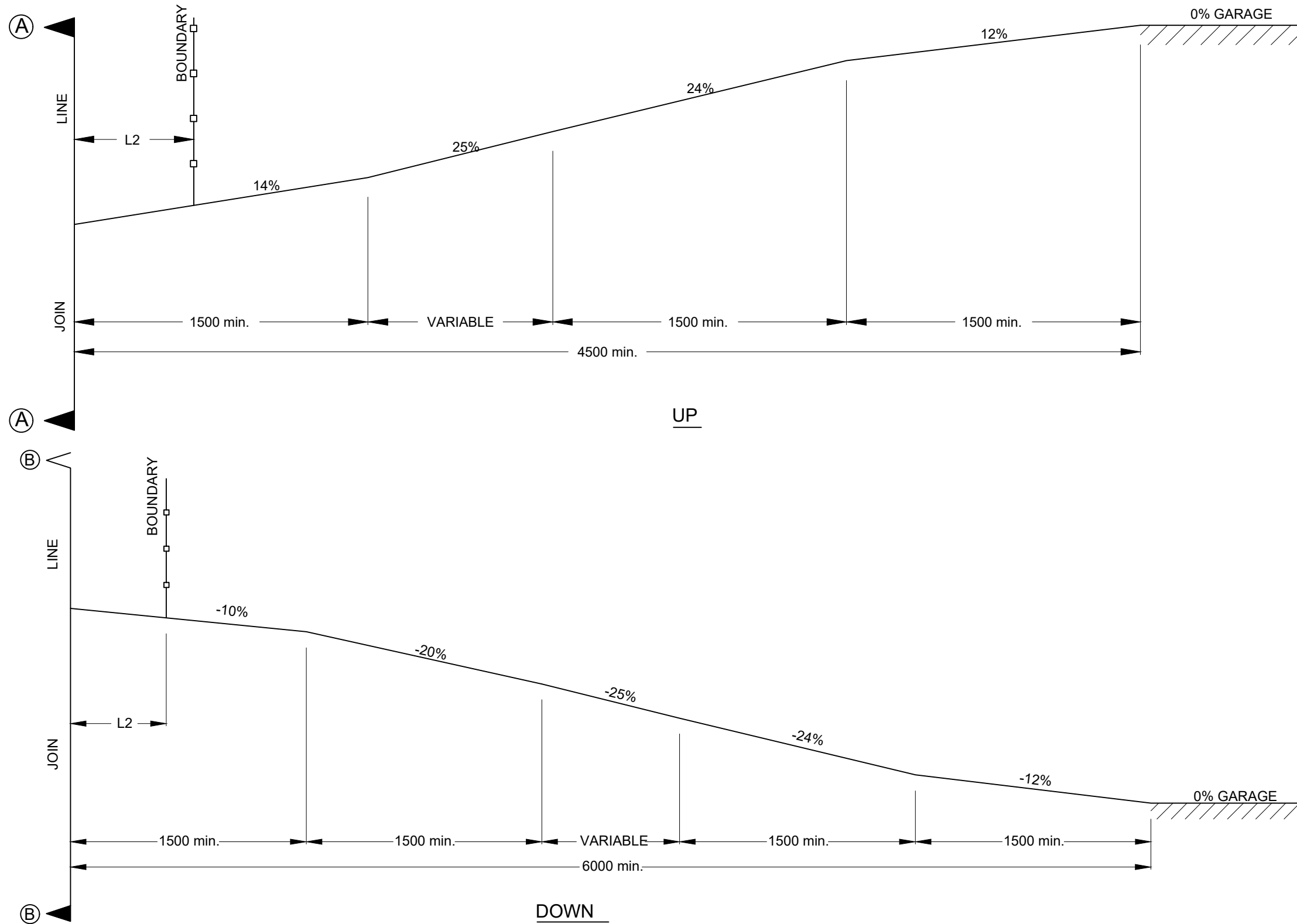

SCALES SURVEYED OFFICER: _____ DATE: _____ SURVEY MARKS: _____	LIST OF REVISIONS REV. DATE OFFICER .A. 18/12/2019 .BT. .B. 17/06/2021 .PW.	AMENDMENT DETAILS	APPROVED - Manager Technical Services DATE: _____ DESIGNED: Patrick Walker DATE: 17/06/2021 DRAWN: Patrick Walker DATE: 17/06/2021	LOCATIONS SERVICES SHOWN ARE THOSE KNOWN TO EXIST AT DATE OF DESIGN. PRIOR TO COMMENCEMENT OF EXCAVATION CONTACT THE RELEVANT GAS, ELECTRICITY, WATER AND TELECOMMUNICATIONS SERVICE PROVIDERS, INCLUDING THE RMS, FOR MOST RECENT SERVICE LOCATIONS AND PRECAUTIONS THAT MAY BE NECESSARY.	SERVICES LEGEND Gas: - - - G - - - Electricity: - - - E - - - Water: - - - W - - - Sewer: - - - S - - - TelComm Local Cable: - - - T - - - TelComm Major or Optic Fibre: - - - MOF - - -	 SHELLHARBOUR CITY COUNCIL	ADMINISTRATION CENTRE SHELLHARBOUR CIVIC CENTRE 76 CYGNET AVENUE (Cnr Cygnet & College Avenue) POSTAL ADDRESS Locked Bag 155 SHELLHARBOUR CITY CENTRE NSW 2529 PH: (02) 4221 6111 FAX: (02) 4221 6016 DX26402 SHELLHARBOUR CITY CENTRE	PLAN DETAILS SCC STANDARD DRAWING DRIVEWAY PROFILES GUIDE INSIDE LOT BOUNDARY		FILE: _____ PLAN No: ASD 206	REVISION B SHEET: _____
	Provide sediment and erosion control measures in accordance with the 'Erosion & Sediment Control' guide by the NSW Office of Environment & Heritage										

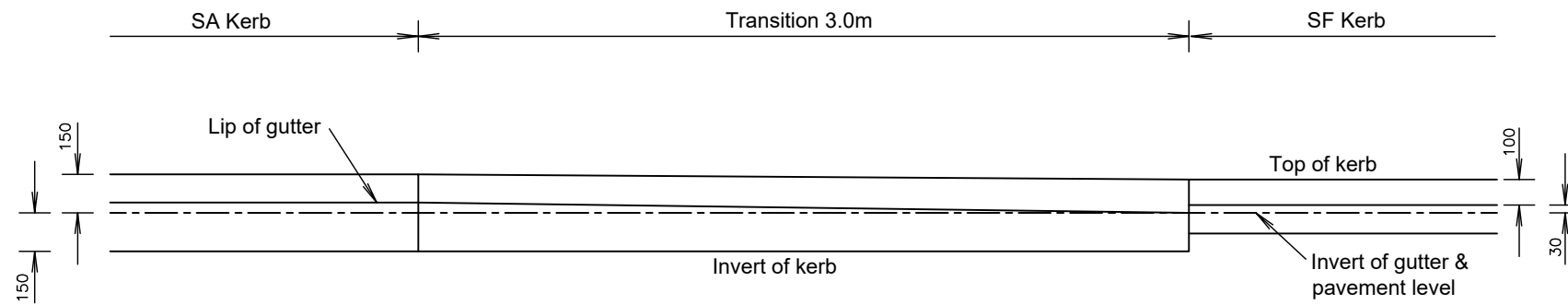

ELEVATION

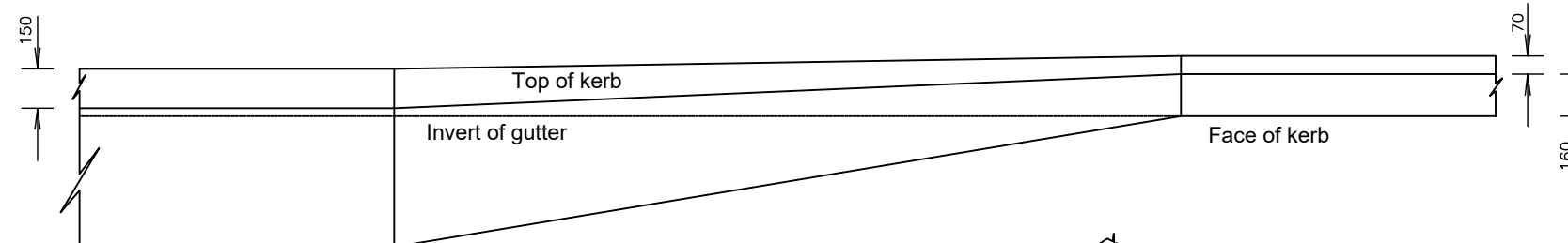

PLAN

NOTES:

1. All dimensions are in millimetres unless otherwise noted

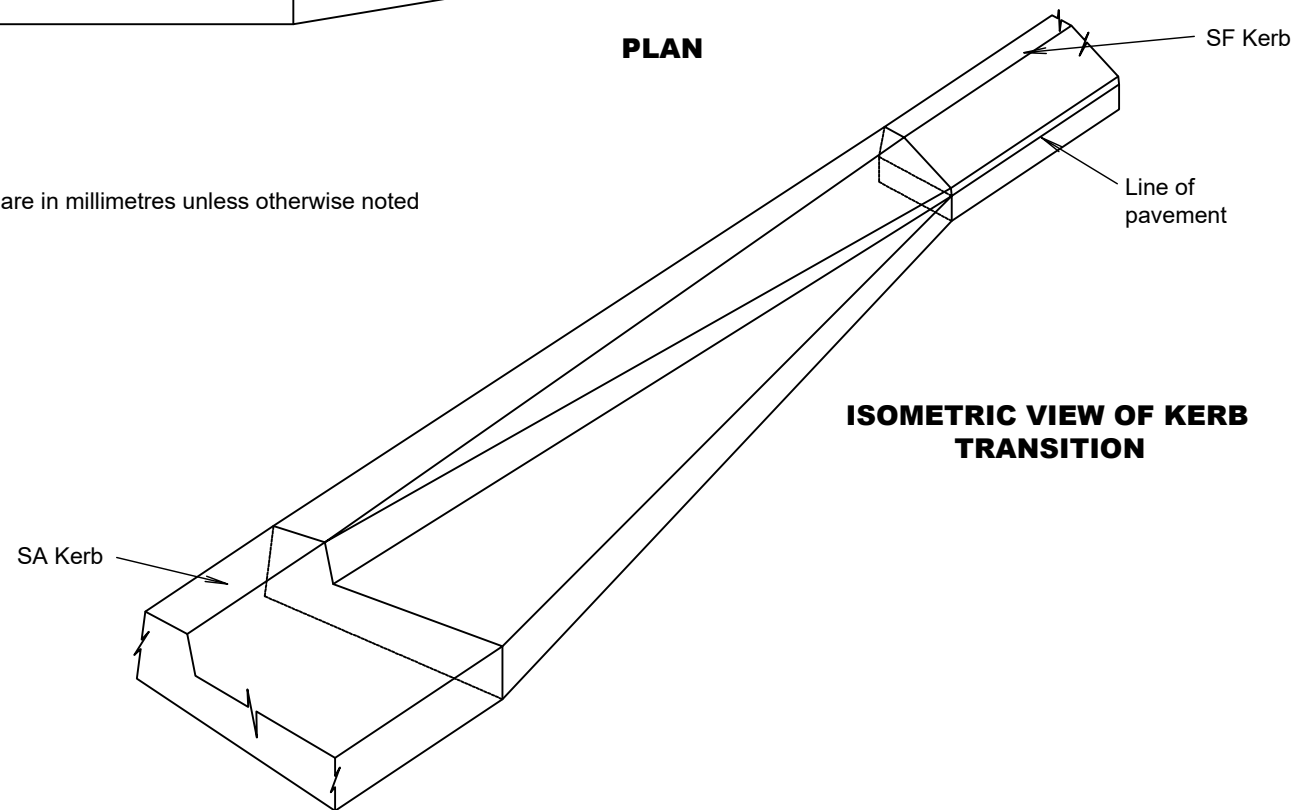

ISOMETRIC VIEW OF KERB TRANSITION

SCALES SURVEYED OFFICER: _____ DATE: _____ SURVEY MARKS: _____	LIST OF REVISIONS REV. DATE OFFICER A 19/12/2019 BH B 17/06/2021 PW	AMENDMENT DETAILS _____ _____	APPROVED - Manager Technical Services DATE: _____ DESIGNED: Patrick Walker DATE: 17/06/2021 DRAWN: Patrick Walker DATE: 17/06/2021	LOCATIONS SERVICES SHOWN ARE THOSE KNOWN TO EXIST AT DATE OF DESIGN. PRIOR TO COMMENCEMENT OF EXCAVATION CONTACT THE RELEVANT GAS, ELECTRICITY, WATER AND TELECOMMUNICATIONS SERVICE PROVIDERS, INCLUDING THE RMS, FOR MOST RECENT SERVICE LOCATIONS AND PRECAUTIONS THAT MAY BE NECESSARY.	SERVICES LEGEND Gas: - - - G - - - Electricity: - - - E - - - Water: - - - W - - - Sewer: - - - S - - - TelComm Local Cable: - - - T - - - TelComm Major or Optic Fibre: - - - MOF - - -	 ADMINISTRATION CENTRE SHELLHARBOUR CIVIC CENTRE 76 CYGNET AVENUE (Cnr Cygnet & College Avenue) POSTAL ADDRESS Locked Bag 155 SHELLHARBOUR CITY CENTRE NSW 2529 PH: (02) 4221 6111 FAX: (02) 4221 6016 DX26402 SHELLHARBOUR CITY CENTRE	PLAN DETAILS KERB TRANSITION - TYPE SA KERB TO TYPE SF KERB		FILE: _____ PLAN No: ASD 207	REVISION B SHEET: _____
	SEDIMENT AND EROSION CONTROL Provide sediment and erosion control measures in accordance with the 'Erosion & Sediment Control' guide by the NSW Office of Environment & Heritage									

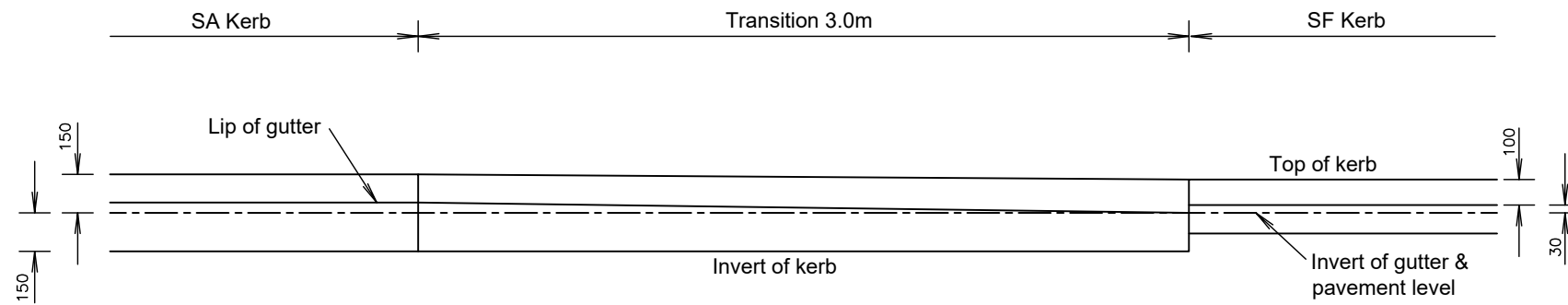

ELEVATION

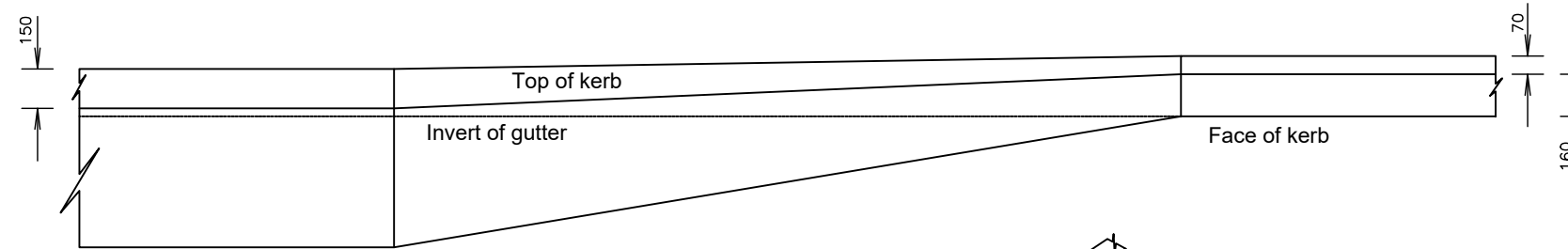

PLAN

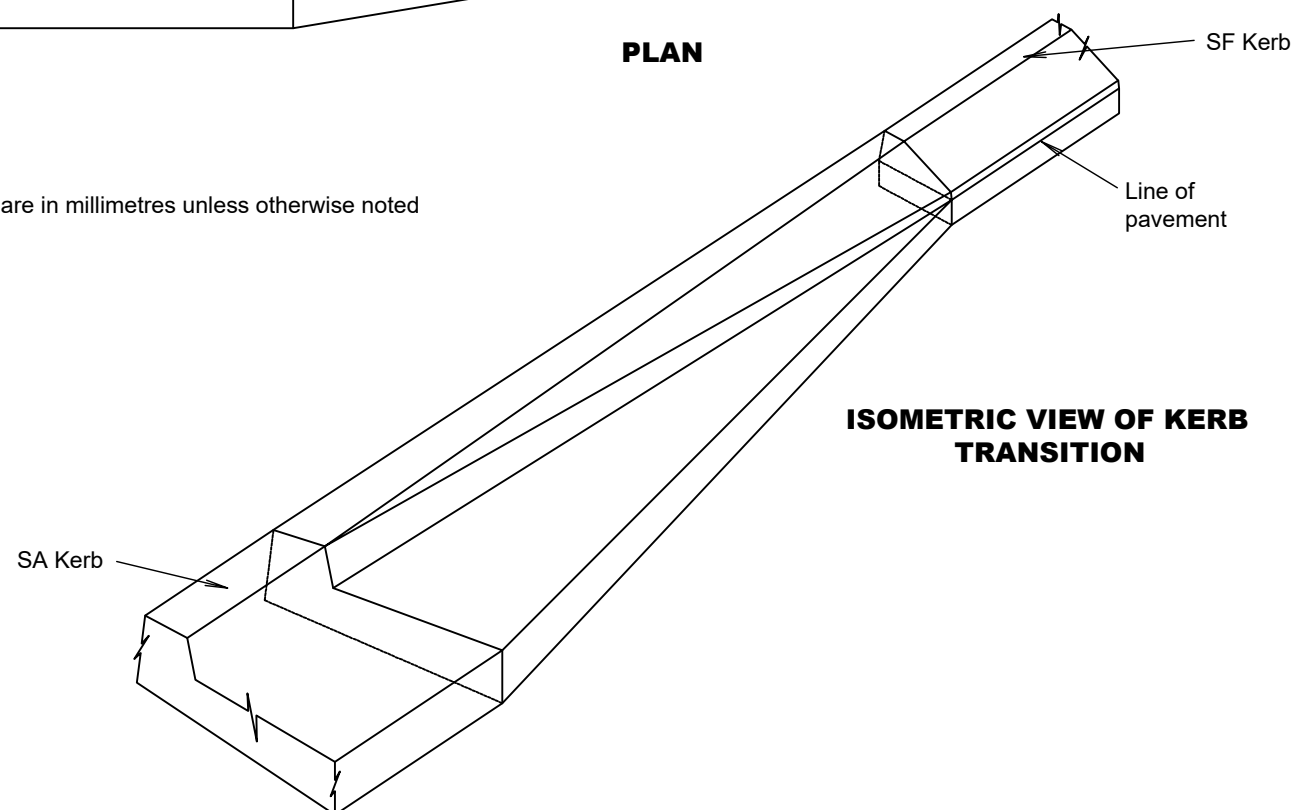

ISOMETRIC VIEW OF KERB TRANSITION

NOTES:

1. All dimensions are in millimetres unless otherwise noted

SCALES SURVEYED: _____ OFFICER: _____ DATE: _____ SURVEY MARKS: _____	LIST OF REVISIONS REV. DATE OFFICER A 19/12/2019 BH B 17/06/2021 PW	AMENDMENT DETAILS _____ _____	APPROVED - Manager Technical Services DATE: _____ DESIGNED: Patrick Walker DATE: 17/06/2021 DRAWN: Patrick Walker DATE: 17/06/2021		LOCATIONS Services shown are those known to exist at date of design. Prior to commencement of excavation contact the relevant gas, electricity, water and telecommunications service providers, including the RMS, for most recent service locations and precautions that may be necessary	SERVICES LEGEND Gas: - - - G - - - Electricity: - - - E - - - Water: - - - W - - - Sewer: - - - S - - - TelComm Local Cable: - - - T - - - TelComm Major or Optic Fibre: - - - MOF - - -	 ADMINISTRATION CENTRE SHELLHARBOUR CIVIC CENTRE 76 CYGNET AVENUE (Cnr Cygnet & College Avenue) POSTAL ADDRESS Locked Bag 155 SHELLHARBOUR CITY CENTRE NSW 2529 PH: (02) 4221 6111 FAX: (02) 4221 6016 DX26402 SHELLHARBOUR CITY CENTRE	PLAN DETAILS KERB TRANSITION - TYPE SA KERB TO TYPE SM KERB		FILE: _____ PLAN No: ASD 208	REVISION B SHEET: _____
				SEDIMENT AND EROSION CONTROL Provide sediment and erosion control measures in accordance with the 'Erosion & Sediment Control' guide by the NSW Office of Environment & Heritage					SHEET: _____		

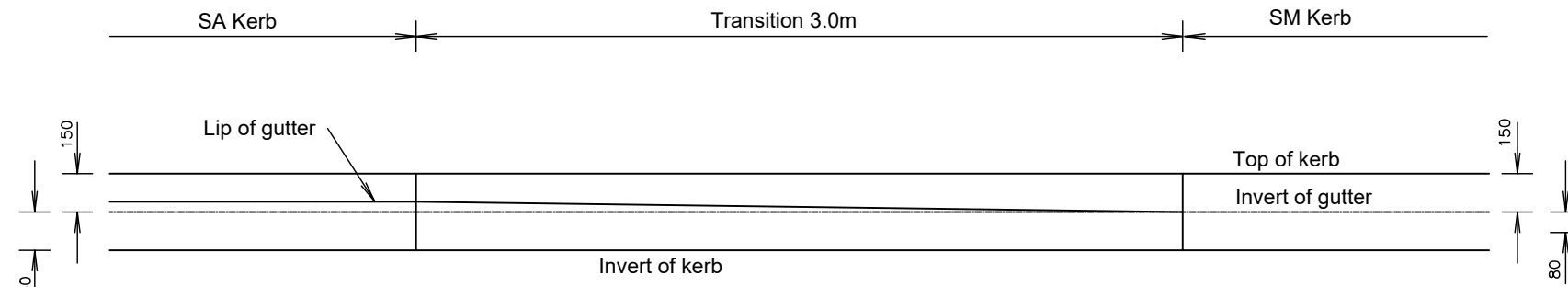

ELEVATION

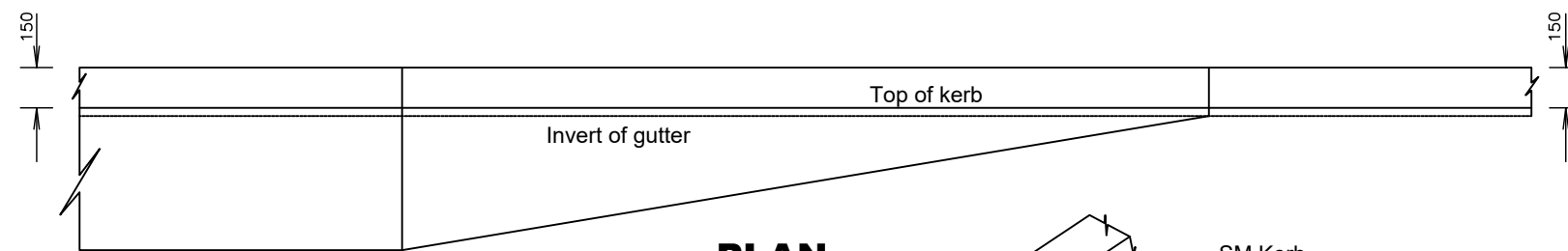

PLAN

NOTES:

1. All dimensions are in millimetres unless otherwise noted

This plan has been adopted from the plan produced by the Roads and Maritime Services NSW (RMS). Drawing Number R0300-6. REFER TO CURRENT EQUIVALENT EDITION BEFORE USING.

ISOMETRIC VIEW OF KERB TRANSITION

SCALES SURVEYED OFFICER: _____ DATE: _____ SURVEY MARKS: _____	LIST OF REVISIONS REV. DATE OFFICER .A. 19/12/2019 .PW. .B. 17/06/2021 .PW.	AMENDMENT DETAILS	APPROVED - Manager Technical Services DATE: _____ DESIGNED: Patrick Walker DATE: 17/06/2021 DRAWN: Patrick Walker DATE: 17/06/2021	LOCATIONS SERVICES SHOWN ARE THOSE KNOWN TO EXIST AT DATE OF DESIGN. PRIOR TO COMMENCEMENT OF EXCAVATION CONTACT THE RELEVANT GAS, ELECTRICITY, WATER AND TELECOMMUNICATIONS SERVICE PROVIDERS, INCLUDING THE RMS, FOR MOST RECENT SERVICE LOCATIONS AND PRECAUTIONS THAT MAY BE NECESSARY.	SERVICES LEGEND Gas: - - - G - - - Electricity: - - - E - - - Water: - - - W - - - Sewer: - - - S - - - TelComm Local Cable: - - - T - - - TelComm Major or Optic Fibre: - - - MOF - - -	 ADMINISTRATION CENTRE SHELLHARBOUR CIVIC CENTRE 76 CYGNET AVENUE (Cnr Cygnet & College Avenue) POSTAL ADDRESS Locked Bag 155 SHELLHARBOUR CITY CENTRE NSW 2529 PH: (02) 4221 6111 FAX: (02) 4221 6016 DX26402 SHELLHARBOUR CITY CENTRE	PLAN DETAILS KERB TRANSITION - TYPE SA KERB TO TYPE SE KERB	FILE: _____ PLAN No: ASD 209 SHEET: _____	REVISION B
	SEDIMENT AND EROSION CONTROL Provide sediment and erosion control measures in accordance with the 'Erosion & Sediment Control' guide by the NSW Office of Environment & Heritage								

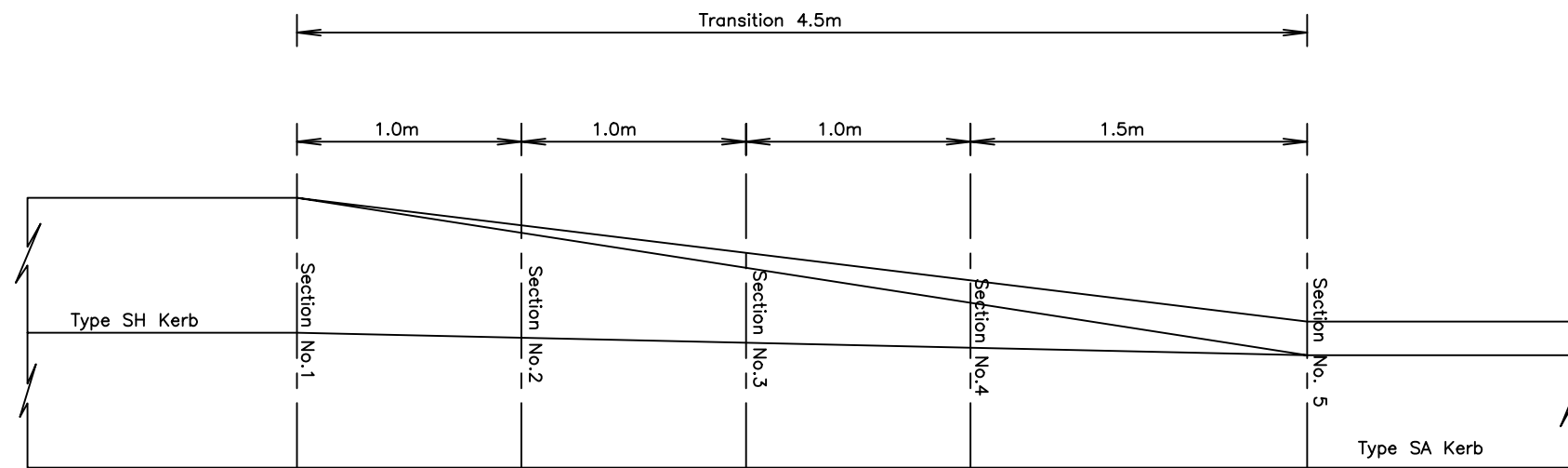

PLAN

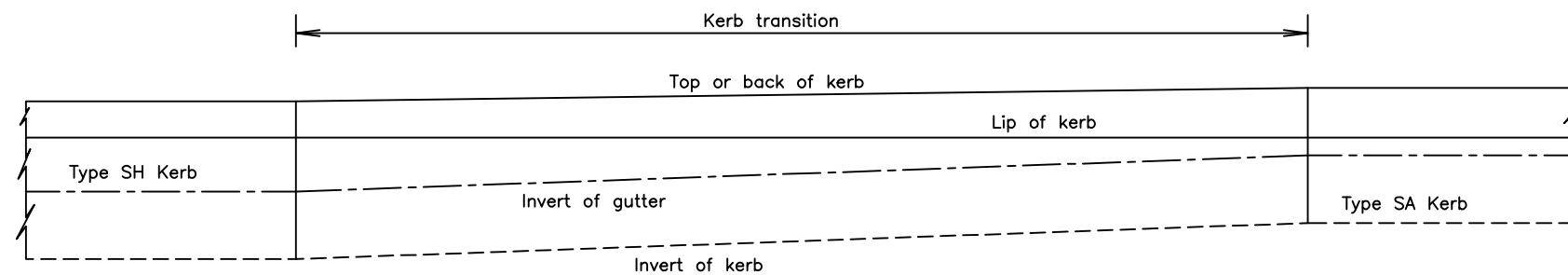

ELEVATION

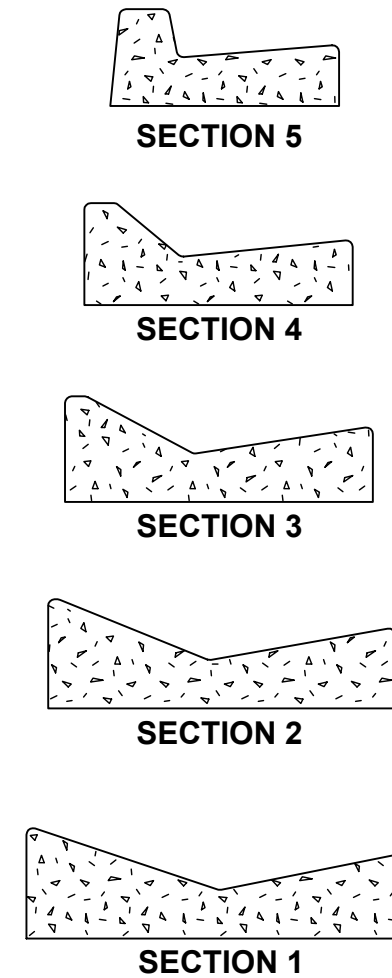

This plan has been adopted from the plan produced by the Roads and Maritime Services NSW (RMS). Drawing Number R0300-09. REFER TO CURRENT EQUIVALENT EDITION BEFORE USING.

SCALES SURVEYED OFFICER: _____ DATE: _____ SURVEY MARKS: _____	LIST OF REVISIONS REV. DATE OFFICER A 19/12/2019 BP B 17/06/2021 PW	AMENDMENT DETAILS	APPROVED - Manager Technical Services DATE: _____ DESIGNED: Patrick Walker DATE: 17/06/2021 DRAWN: Patrick Walker DATE: 17/06/2021	LOCATIONS SERVICES shown are those known to exist at date of design. Prior to commencement of excavation contact the relevant gas, electricity, water and telecommunications service providers, including the RMS, for most recent service locations and precautions that may be necessary.	SERVICES LEGEND Gas: — G — Electricity: — E — Water: — W — Sewer: — S — TelComm Local Cable: — T — TelComm Major or Optic Fibre: — MOF —	 ADMINISTRATION CENTRE SHELLHARBOUR CIVIC CENTRE 76 CYGNET AVENUE (Cnr Cygnet & College Avenue) POSTAL ADDRESS Locked Bag 155 SHELLHARBOUR CITY CENTRE NSW 2529 PH: (02) 4221 6111 FAX: (02) 4221 6016 DX26402 SHELLHARBOUR CITY CENTRE	PLAN DETAILS KERB TRANSITION - TYPE SH DRAIN TO TYPE SA KERB	FILE: _____ PLAN No: ASD 210	REVISION B SHEET: _____
--	---	--------------------------	--	---	---	--	---	---------------------------------	--------------------------------------

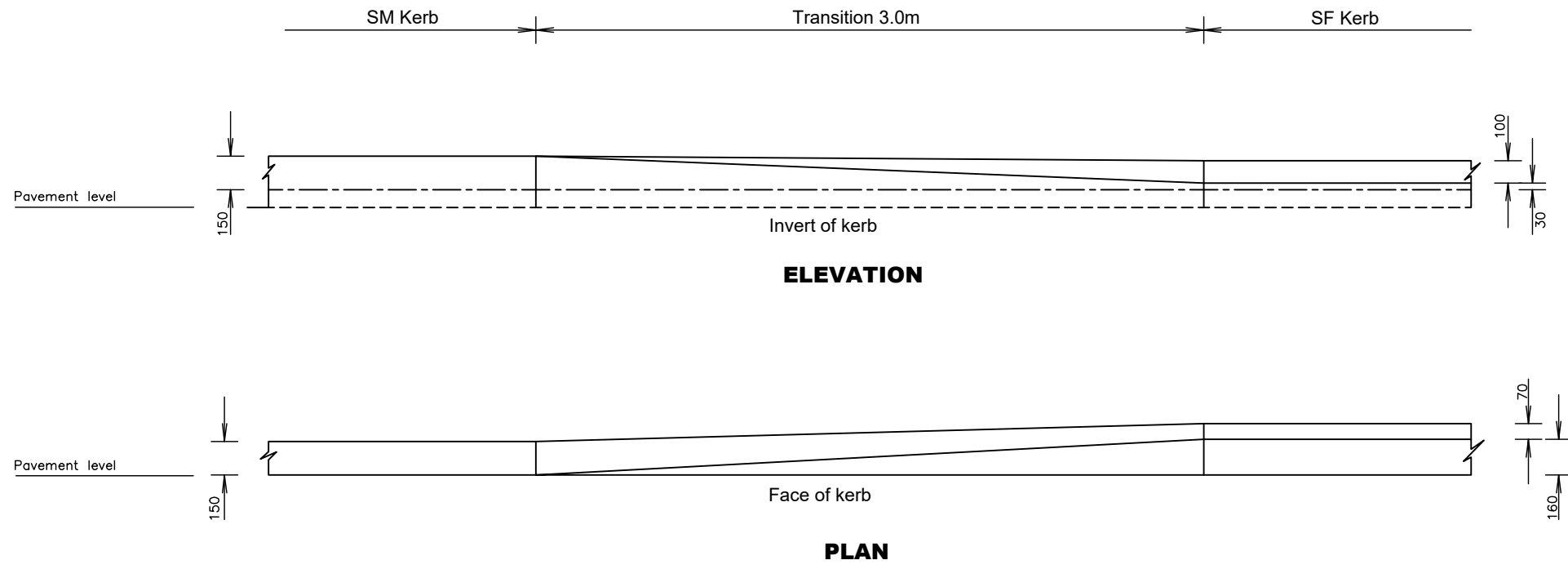

ELEVATION

PLAN

NOTES:

1. All dimensions are in millimetres unless otherwise noted

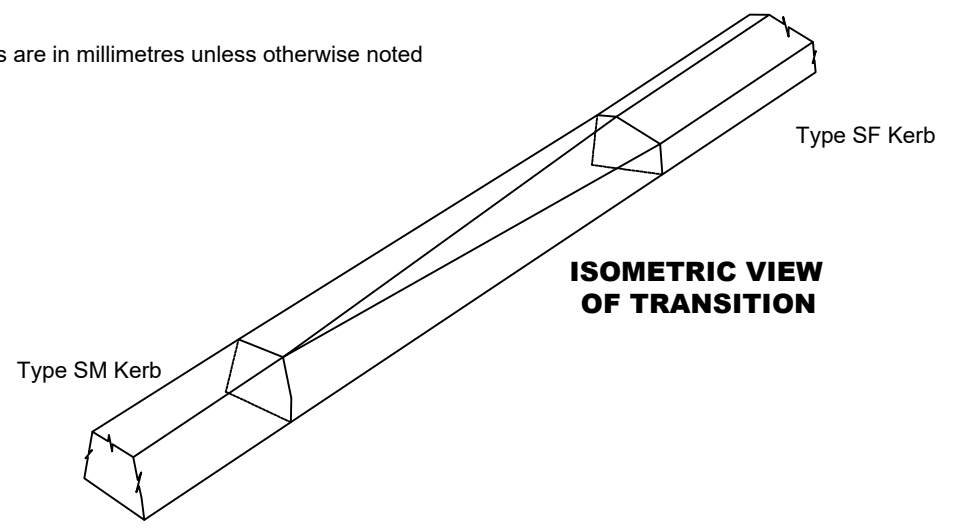

ISOMETRIC VIEW OF TRANSITION

This plan has been adopted from the plan produced by the Roads and Maritime Services NSW (RMS). Drawing Number R0300-10. REFER TO CURRENT EQUIVALENT EDITION BEFORE USING.

SCALES SURVEYED OFFICER: _____ DATE: _____ SURVEY MARKS: _____	LIST OF REVISIONS REV. DATE OFFICER .A. 18/12/2019 .BT. .B. 17/06/2021 .PW.	AMENDMENT DETAILS	APPROVED - Manager Technical Services DATE: _____ DESIGNED: Patrick Walker DATE: 17/06/2021 DRAWN: Patrick Walker DATE: 17/06/2021	LOCATIONS SERVICES SHOWN ARE THOSE KNOWN TO EXIST AT DATE OF DESIGN. PRIOR TO COMMENCEMENT OF EXCAVATION CONTACT THE RELEVANT GAS, ELECTRICITY, WATER AND TELECOMMUNICATIONS SERVICE PROVIDERS, INCLUDING THE RMS, FOR MOST RECENT SERVICE LOCATIONS AND PRECAUTIONS THAT MAY BE NECESSARY.	SERVICES LEGEND Gas: — G — Electricity: — E — Water: — W — Sewer: — S — TelComm Local Cable: — T — TelComm Major or Optic Fibre: — MOF —	 ADMINISTRATION CENTRE SHELLHARBOUR CIVIC CENTRE 76 CYGNET AVENUE (Cnr Cygnet & College Avenue) POSTAL ADDRESS Locked Bag 155 SHELLHARBOUR CITY CENTRE NSW 2529 PH: (02) 4221 6111 FAX: (02) 4221 6016 DX26402 SHELLHARBOUR CITY CENTRE	PLAN DETAILS KERN TRANSITION - TYPE SM DRAIN TO TYPE SF KERB	FILE: _____ PLAN No: ASD 211	REVISION B SHEET: _____
	SEDIMENT AND EROSION CONTROL Provide sediment and erosion control measures in accordance with the 'Erosion & Sediment Control' guide by the NSW Office of Environment & Heritage								

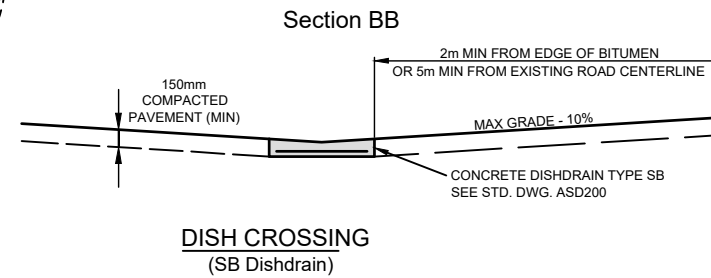
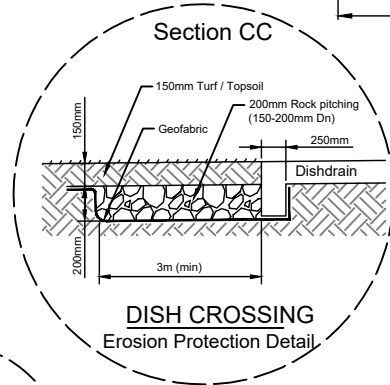
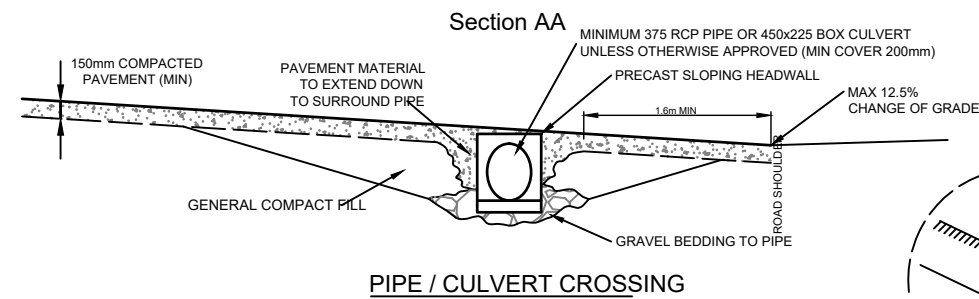
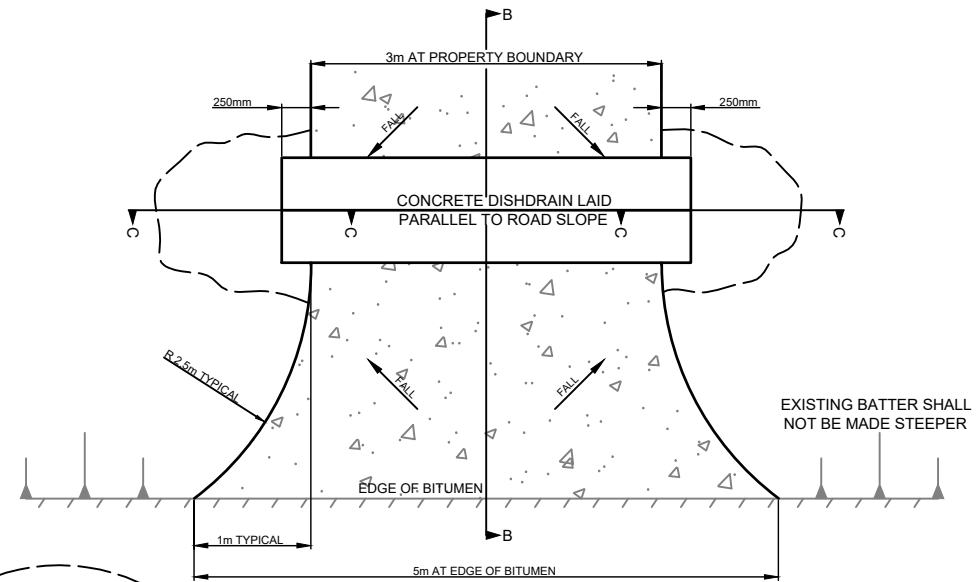
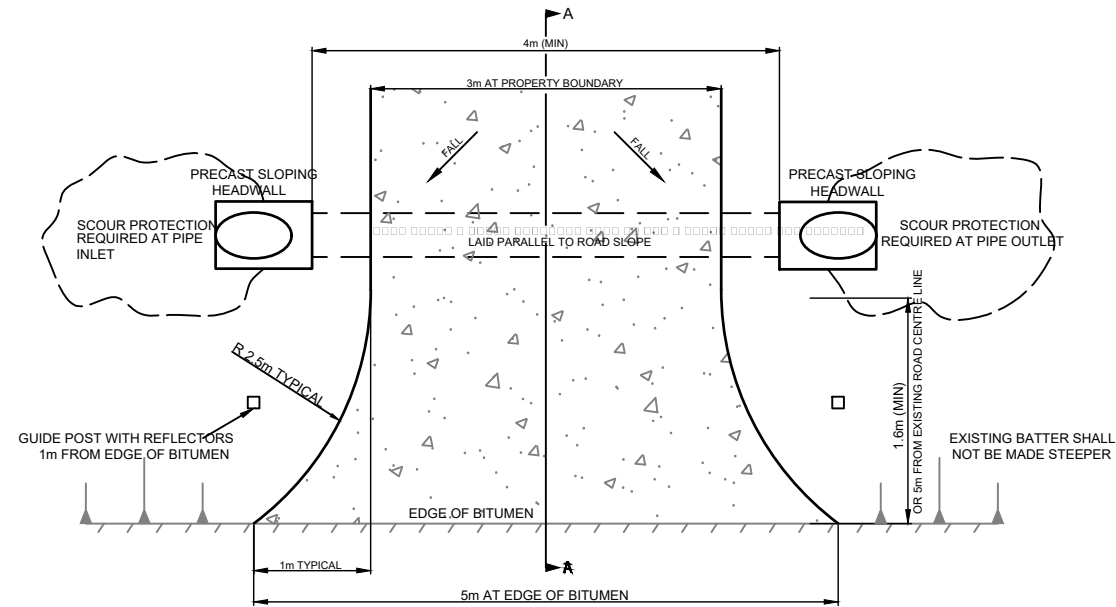

NOTES:

1. Maximum desirable longitudinal grade of 12%. Private access roads with longitudinal grade greater than 15% are to be sealed. Absolute maximum permissible grade is 25%.
2. Where the existing road is sealed the driveway is to be sealed to a minimum 3m within the property boundary.
3. For driveway change of grade greater than 12.5% provide 3.0m transition.
4. Driveway profiles are to conform to the requirements of AS 2890.1 Parking Facilities - Off - Street Car Parking.
5. All dimensions in millimetres unless otherwise noted.
6. Where standard designs cannot be implemented, eg. due to natural surface levels, low points in the road, etc, alternative design should be submitted to Council for consideration. Particular attention shall be made to ensure properties which are below the road level do not create a stormwater overland flow path.
7. Provide scour protection at pipe inlet & outlet.
8. Use appropriate pipe class for the situation

SCALES SURVEYED OFFICER: DATE: SURVEY MARKS:	LIST OF REVISIONS REV. DATE OFFICER A 19/12/2019 BH B 17/06/2021 PW	AMENDMENT DETAILS APPROVED - Manager Technical Services DATE:	DESIGNED: Patrick Walker DATE: 17/06/2021 DRAWN: Patrick Walker DATE: 17/06/2021	SERVICES Gas: G Electricity: E Water: W Sewer: S TelComm Local Cable: T TelComm Major or Optic Fibre: MOF	LEGEND Gas: G Electricity: E Water: W Sewer: S TelComm Local Cable: T TelComm Major or Optic Fibre: MOF	 ADMINISTRATION CENTRE SHELLHARBOUR CIVIC CENTRE 76 CYGNET AVENUE (Cnr Cygnet & College Avenue) POSTAL ADDRESS SHELLHARBOUR CITY CENTRE NSW 2529 PH: (02) 4221 6111 FAX: (02) 4221 6016 DX26402 SHELLHARBOUR CITY CENTRE	PLAN DETAILS RURAL DRIVEWAY CONSTRUCTION DETAILS		FILE:	REVISION B
	PLAN No: ASD 212						SHEET:			

FOOTPATH WIDTH	L1	L2	L3
2740	790	300	1240
3050	1100	300	1550
3350	1400	300	1850
3660	1400	610	1850
4570	1400	1520	1850

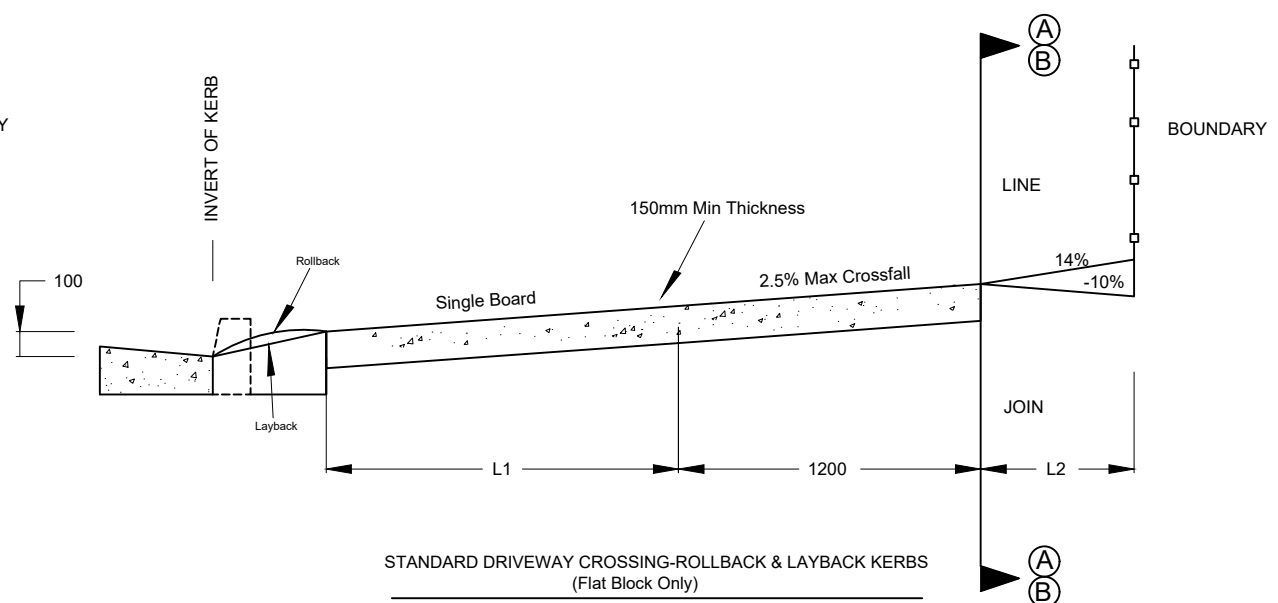
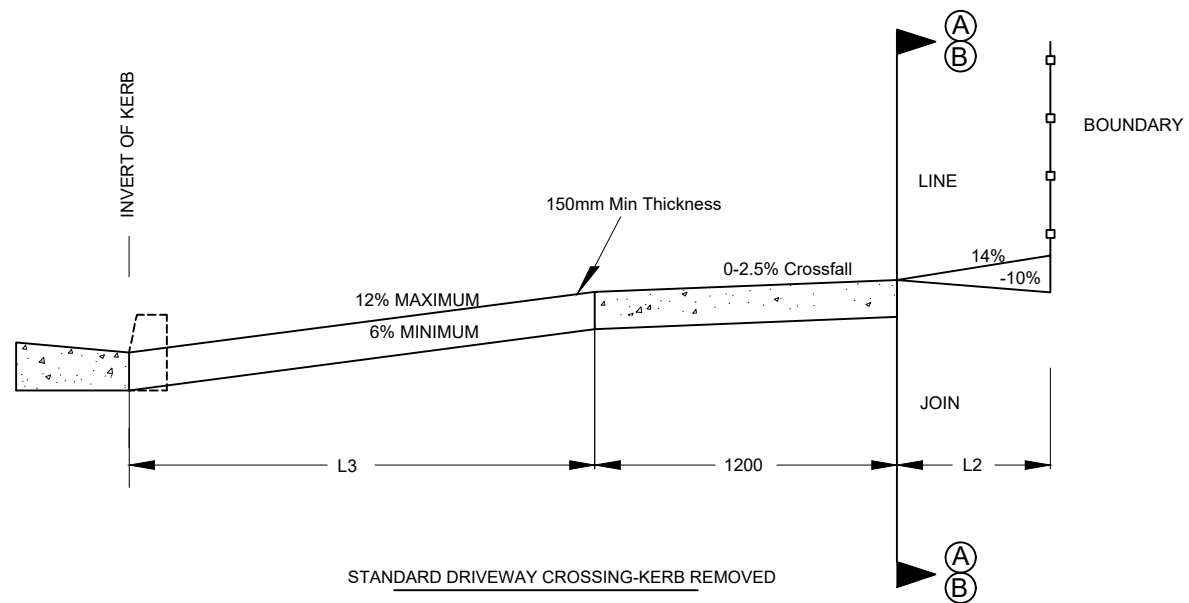
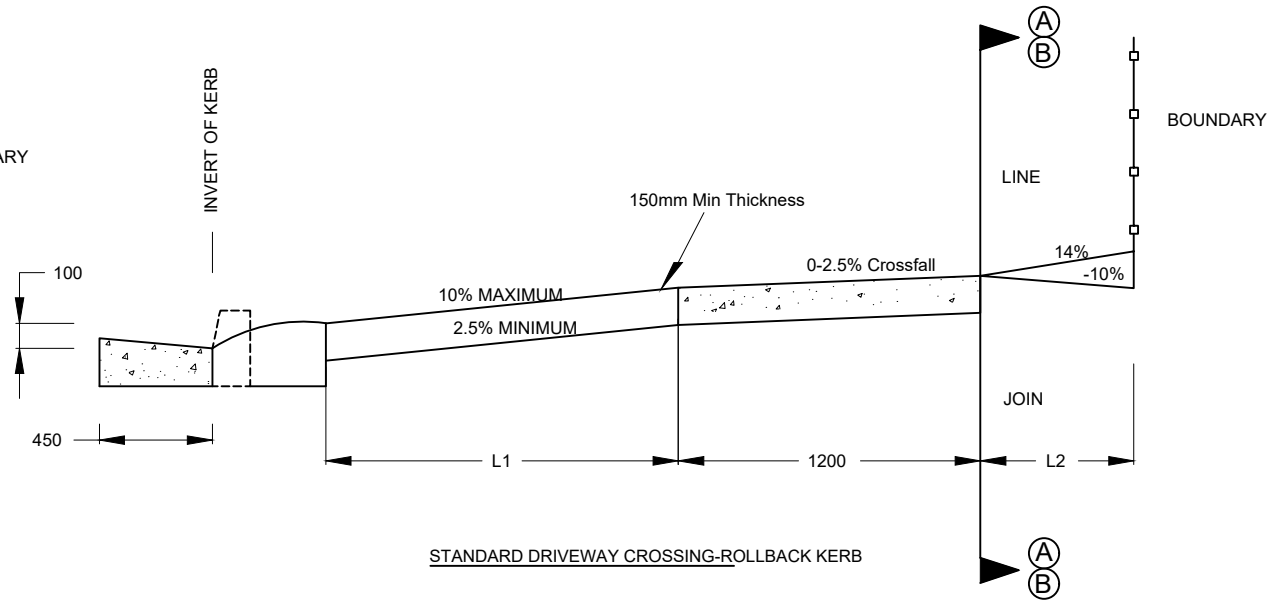
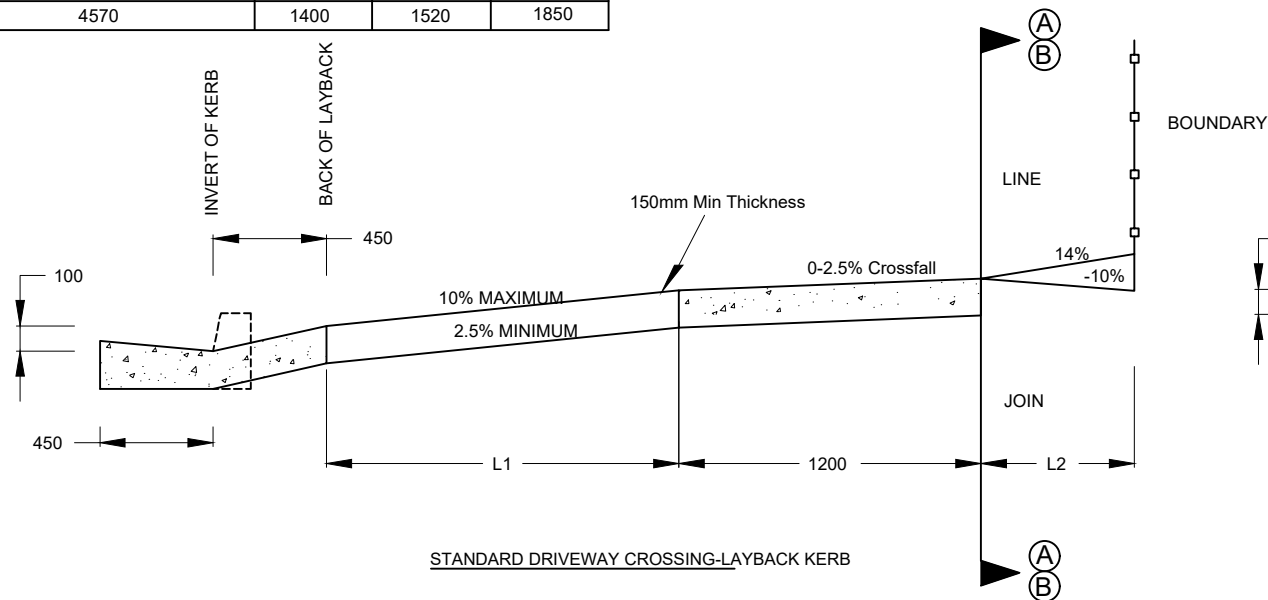

SCALES SURVEYED: _____ OFFICER: _____ DATE: _____ SURVEY MARKS: _____	LIST OF REVISIONS REV. DATE OFFICER .A. 18/12/2019 .BH. .B. 17/06/2021 .PW.	AMENDMENT DETAILS _____ _____	APPROVED - Manager Technical Services DATE: _____		LOCATIONS Services shown are those known to exist at date of design. Prior to commencement of excavation contact the relevant gas, electricity, water and telecommunications service providers, including the RMS, for most recent service locations and precautions that may be necessary	SERVICES Legend: Gas: - G - Electricity: - E - Water: - W - Sewer: - S - TelComm Local Cable: - T - TelComm Major or Optic Fibre: - MOF -	 ADMINISTRATION CENTRE SHELLHARBOUR CIVIC CENTRE 76 CYGNET AVENUE (Cnr Cygnet & College Avenue) POSTAL ADDRESS Locked Bag 155 SHELLHARBOUR CITY CENTRE NSW 2529 PH: (02) 4221 6111 FAX: (02) 4221 6016 DX26402 SHELLHARBOUR CITY CENTRE	PLAN DETAILS SCC STANDARD DRAWING DRIVEWAY PROFILES ROAD RESERVE		FILE: _____ PLAN No: _____ ASD 213	REVISION B SHEET: _____
			DESIGNED: Patrick Walker DATE: 17/06/2021 DRAWN: Patrick Walker DATE: 17/06/2021	SEDIMENT AND EROSION CONTROL Provide sediment and erosion control measures in accordance with the 'Erosion & Sediment Control' guide by the NSW Office of Environment & Heritage							

Driveways minimum of 6m from tangent point of street curve (corner sites)

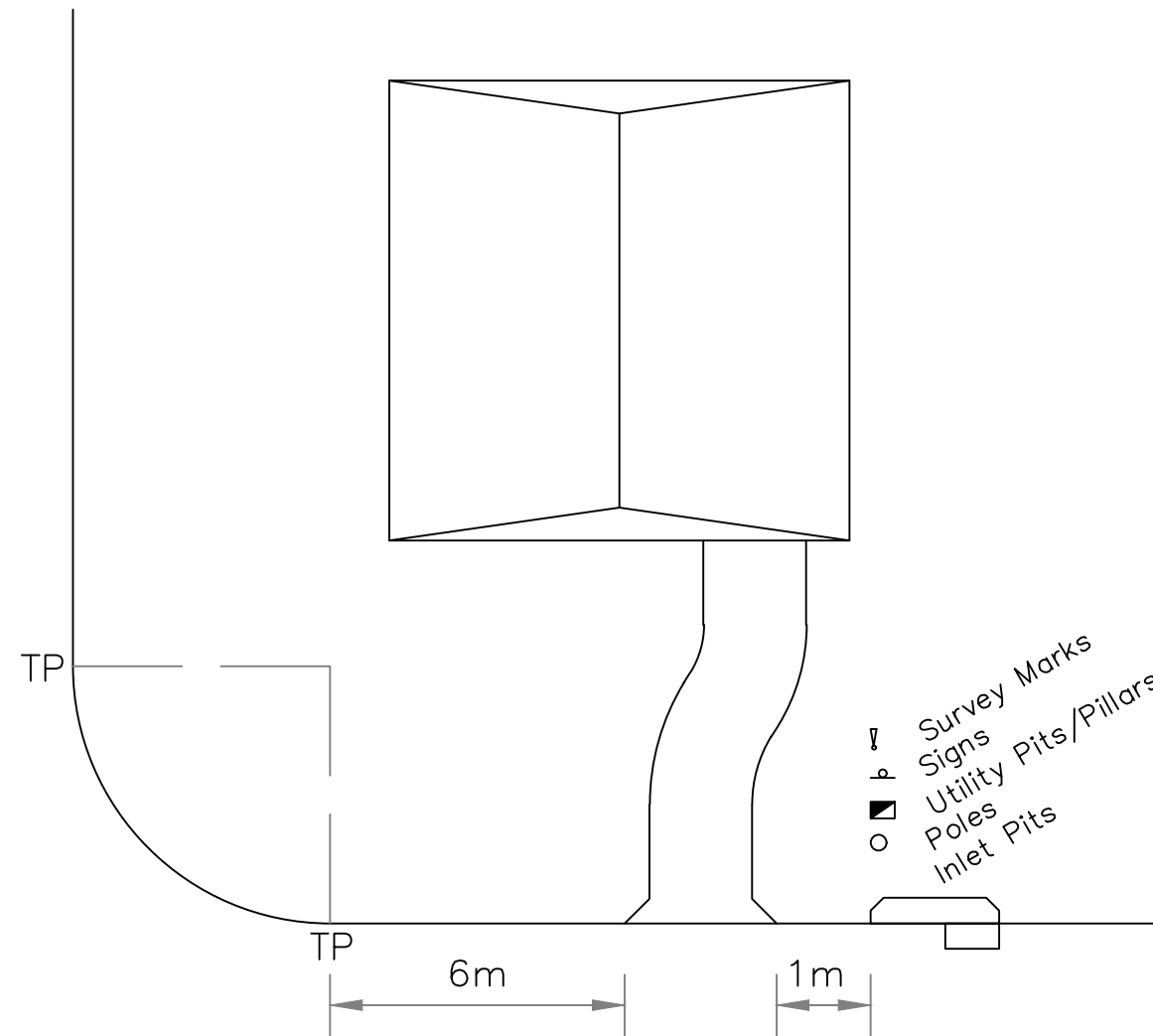

SCALES	LIST OF REVISIONS	AMENDMENT DETAILS	APPROVED - Manager Technical Services		LOCATIONS	SERVICES	LEGEND	 ADMINISTRATION CENTRE SHELLHARBOUR CIVIC CENTRE 76 CYGNET AVENUE (Cnr Cygnet & College Avenue) POSTAL ADDRESS Locked Bag 155 SHELLHARBOUR CITY CENTRE NSW 2529 PH: (02) 4221 6111 FAX: (02) 4221 6016 DX26402 SHELLHARBOUR CITY CENTRE	PLAN DETAILS	FILE:	REVISION
SURVEYED: _____ OFFICER: _____ DATE: _____ SURVEY MARKS: _____	REV. DATE OFFICER .A. 18/12/2019 .BH. .B. 17/06/2021 .PW.		DESIGNED: Patrick Walker DATE: 17/06/2021 DRAWN: Patrick Walker DATE: 17/06/2021	SEDIMENT AND EROSION CONTROL Provide sediment and erosion control measures in accordance with the 'Erosion & Sediment Control' guide by the NSW Office of Environment & Heritage	Services shown are those known to exist at date of design. Prior to commencement of excavation contact the relevant gas, electricity, water and telecommunications service providers, including the RMS, for most recent service locations and precautions that may be necessary	Gas: — G — Electricity: — E — Water: — W — Sewer: — S — TelComm Local Cable: — T — TelComm Major or Optic Fibre: — MOF —	SHELLHARBOUR CITY COUNCIL		SCC STANDARD DRAWING DRIVEWAY LOCATION ON CORNERS		

PLAN No: **ASD 214** SHEET: